

# ZELA *Tilt*



Nelson private residence  
Modo Architects | Tasman Sparkies



**SLDL214T**  
Lens  
9° 15° 20°  
Spot lighting

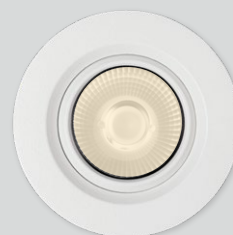

**SLDL217T**  
Asymmetric  
20°x 55°  
Wall washing



**SLDL216T**  
Honeycomb  
30° 40°  
Anti-glare lighting



**SLDL212T**  
ULG clear  
40° 55°  
Task | General lighting



**SLDL211T**  
Prismatic diffuser  
40° 55°  
General | Task lighting

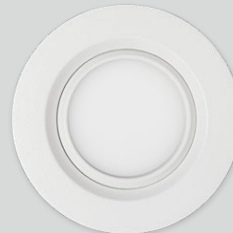

**SLDL213T**  
Opaque diffuser  
90°  
Wide angle lighting



# ZELA Tilt

- + illuminate with elegance and precision
- + general all purpose luminaire
- + fully adjustable 360° gimbal
- + suitable for indoor use and exterior under soffits
- + IP65 front
- + constant current

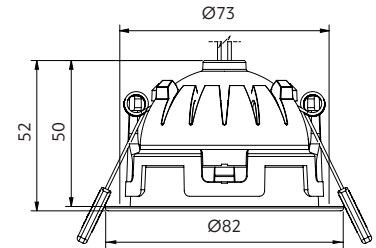

## Options

### Beam angle

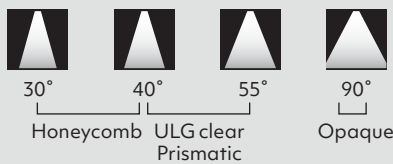

### Trim colour



### CCT



<sup>1</sup> Sunset Dimming is available in 30°, 40° and 55° in Professional series.

<sup>2</sup> Tunable White is available in Asymmetric and 20°, 30°, 40°, 55° in Art series.

### CRI

Professional series (P) 90-94CRI Art series (A) 95-98CRI

### Use with

ZELA adapter plates for retrofit installations

### Driver included – to be specified

Phase cut Dimming  
 DALI 2 Tunable White  
 DALI 2 Dimming  
 SLiC Casambi Tunable White  
 SLiC Casambi Dimming

9-36VDC input options available

Scan the QR code for low voltage driver options



## Product information

**Table is based on:** White, prismatic, 40°, 3000K, CRI 90, phase cut driver  
Contact Switch Lighting for data of other variants

Driver (mA)	Power (W)	Delivered lumens (lm)	Insulation coverable		
			NZ	AU	UK/EU
100	4.3	420	IC-F	IC-4	✓
150	6.4	590	IC-F	IC-4	✓
180	7.7	690	IC-F	IC-4	✓
220	9.4	810	IC-F	IC-4	✓
260	11.1	910	CA135	CA90	✓



Tilt Angle 28°



Size 82x50mm



Cut-out Ø73mm



Hole depth >67mm\*



Front

\*Specification is for ceiling material ≤ 13mm with a phase cut driver.

## How to specify ZELA Tilt

Please confirm model option availability from our website. **Not every combination is compatible.**

e.g. code = **SLDL211T-4030P-TWD10**

Model	Beam	CCT	CRI	Trim Colour	Driver	Market
SLDL214T = Lens	09 = 9° 15 = 15° 20 = 20°	24 = 2400K 27 = 2700K 30 = 3000K 40 = 4000K	P = 90-94 A = 95-98	TW = Textured White TB = Textured Black	<b>Phase cut Dimming</b> D08 = 100mA (4.3W) D09 = 150mA (6.4W) D15 = 180mA (7.7W) D10 = 220mA (9.4W) D11 = 260mA (11.1W) <b>DALI 2 Tunable White</b> D42 = 180mA (8.3W) D43 = 230mA (10.1W) D44 = 260mA (11.9W)	1 = NZ 2 = UK 3 = EU
SLDL216T = Honeycomb	30 = 30° 40 = 40°	SD = Sunset Dimming S2 = Tunable White			<b>DALI 2 Dimming</b> D02 = 150mA (8.3W) D03 = 200mA (10.1W) D04 = 250mA (11.9W) <b>SLiC Casambi Tunable White</b> D52 = 180mA (8.2W) <b>SLiC Casambi Dimming</b> D57 = 180mA (7.7W) D58 = 220mA (9.4W) <b>Check online for other driver options.</b>	
SLDL212T = ULG clear glass SLDL211T = Prismatic	40 = 40° 55 = 55°					
SLDL217T Asymmetric	W3=20°x55°					
SLDL213T = Opaque	90 = 90°					

Please see [www.switch-lighting.co.nz](http://www.switch-lighting.co.nz) for full specifications, lux levels, SDoCs, ies files and installation instructions.



**Warranty**  
7yr Luminaire  
5yr Driver

L70 (60,000 h)

