

# ZELA LUMINAIRES

Delivering optical clarity and beam control in beautiful forms, our premium range of ZELA recessed LED downlights opens up the possibilities for creative lighting design like never before.

The premium range of ZELA recessed LED downlights deliver superb optical clarity and beam control in stylish forms.

By blending LEDs with Pure Colour rendering, precise reflectors, controlled diffusion and excellent beam options, ZELA luminaires improve the depth, form and 3-dimensionality of a space. So you can create environments that elevate and inspire.





Our latest 3rd generation lighting technology – the ZELA range, is in a constant state of expansion. With its modern design and slim trim options, this range encompasses a diverse selection, featuring both sophisticated architectural designs and trusted fire-rated models. All luminaires are IP65 front facing with a choice of black (B104) and white (RAL9016) textured matt paint finishes.

With beam angles of 9°, 15°, 20°, 30°, 40°, 55° and 90° available in most styles in 2700K, 3000K and 4000K options. A 2400K option is also available in all angles except 9° and 15°.

For general lighting, the Sunset Dimming and Tunable White options are highly favoured, and are available in 20°, 30°, 40° & 55° variants.



9°



15°



20°



40°



55°



90°

# ZELA *Tilt*



Nelson private residence  
Modo Architects | Tasman Sparkies



**SLDL214T**  
Lens  
9° 15° 20°  
Spot lighting

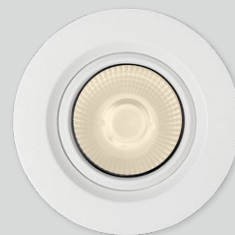

**SLDL217T**  
Asymmetric  
20°x 55°  
Wall washing



**SLDL216T**  
Honeycomb  
30° 40°  
Anti-glare lighting



**SLDL212T**  
ULG clear  
40° 55°  
Task | General lighting

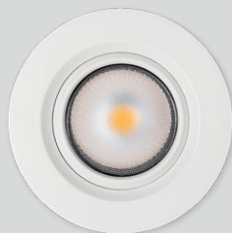

**SLDL211T**  
Prismatic diffuser  
40° 55°  
General | Task lighting

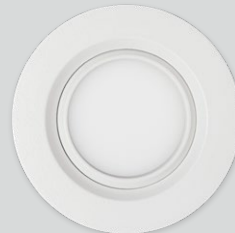

**SLDL213T**  
Opaque diffuser  
90°  
Wide angle lighting



# ZELA Tilt

- + illuminate with elegance and precision
- + general all purpose luminaire
- + fully adjustable 360° gimbal
- + suitable for indoor use and exterior under soffits
- + IP65 front
- + constant current

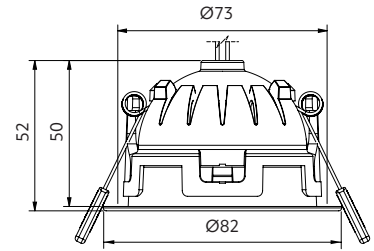

## Options

### Beam angle

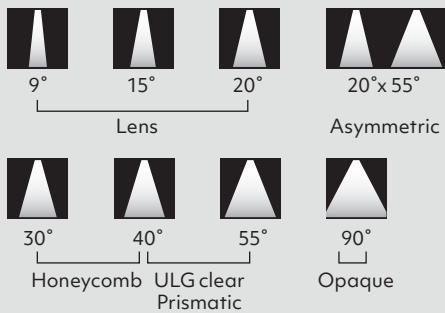

### Trim colour

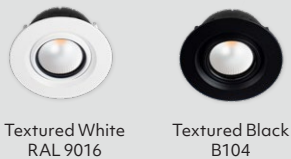

### CCT



<sup>1</sup> Sunset Dimming is available in 30°, 40° and 55° in Professional series.  
<sup>2</sup> Tunable White is available in Asymmetric and 20°, 30°, 40°, 55° in Art series.

### CRI

Professional series (P) 90-94CRI Art series (A) 95-98CRI

### Use with

ZELA adapter plates for retrofit installations

### Driver included – to be specified

- Phase cut Dimming
- DALI 2 Tunable White
- DALI 2 Dimming
- SLiC Casambi Tunable White
- SLiC Casambi Dimming

9-36VDC input options available  
 Scan the QR code for low voltage driver options



## Product information

**Table is based on:** White, prismatic, 40°, 3000K, CRI 90, phase cut driver  
 Contact Switch Lighting for data of other variants

Driver (mA)	Power (W)	Delivered lumens (lm)	Insulation coverable		
			NZ	AU	UK/EU
100	4.3	420	IC-F	IC-4	✓
150	6.4	590	IC-F	IC-4	✓
180	7.7	690	IC-F	IC-4	✓
220	9.4	810	IC-F	IC-4	✓
260	11.1	910	CA135	CA90	✓



\*Specification is for ceiling material ≤ 13mm with a phase cut driver.

## How to specify ZELA Tilt

Please confirm model option availability from our website. **Not every combination is compatible.**

e.g. code = **SLDL211T-4030P-TWD10**

Model	Beam	CCT	CRI	Trim Colour	Driver	Market
SLDL214T = Lens	09 = 9° 15 = 15° 20 = 20°	24 = 2400K 27 = 2700K 30 = 3000K 40 = 4000K	P = 90-94 A = 95-98	TW = Textured White TB = Textured Black	<b>Phase cut Dimming</b> D08 = 100mA (4.3W) D09 = 150mA (6.4W) D15 = 180mA (7.7W) D10 = 220mA (9.4W) D11 = 260mA (11.1W) <b>DALI 2 Tunable White</b> D42 = 180mA (8.3W) D43 = 230mA (10.1W) D44 = 260mA (11.9W)	1 = NZ 2 = UK 3 = EU
SLDL216T = Honeycomb	30 = 30° 40 = 40°	SD = Sunset Dimming S2 = Tunable White			<b>DALI 2 Dimming</b> D02 = 150mA (8.3W) D03 = 200mA (10.1W) D04 = 250mA (11.9W) <b>SLiC Casambi Tunable White</b> D52 = 180mA (8.2W) <b>SLiC Casambi Dimming</b> D57 = 180mA (7.7W) D58 = 220mA (9.4W) <b>Check online for other driver options.</b>	
SLDL212T = ULG clear glass SLDL211T = Prismatic	40 = 40° 55 = 55°					
SLDL217T Asymmetric	W3=20°x 55°					
SLDL213T = Opaque	90 = 90°					

Please see [www.switch-lighting.co.nz](http://www.switch-lighting.co.nz) for full specifications, lux levels, SDoCs, ies files and installation instructions.



**Warranty**  
7yr Luminaire  
5yr Driver

L70 (60,000 h)

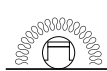

# ZELA Tilt 2

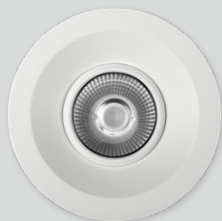

**SLDL234T**  
Lens  
Beam 9° 15° 20°  
Spot lighting



**SLDL237T**  
Asymmetric  
20°x55°  
Wall washing



**SLDL236T**  
Honeycomb  
30° 40°  
Anti-glare lighting



**SLDL230T**  
Clear glass  
Beam 40° 55°  
Task | General lighting



**SLDL231T**  
Prismatic diffuser  
Beam 40° 55°  
General | Task lighting

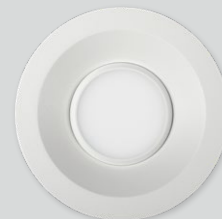

**SLDL233T**  
Opaque diffuser  
Beam 90°  
Wide angle lighting



# ZELA Tilt 2

- + timeless modern design, recessed for low glare
- + general all purpose luminaire
- + fully adjustable 360° gimbal
- + suitable for indoor use and exterior under soffits
- + IP65 front
- + constant current

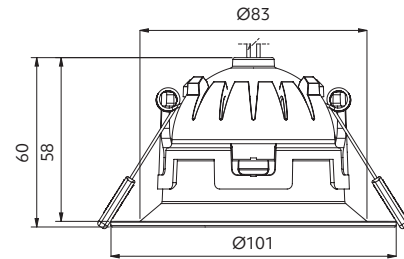

## Options

### Beam angle

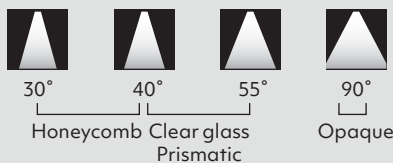

### Trim colour



### CCT



<sup>1</sup> Sunset Dimming is available in 30°, 40° and 55° in Professional series.

<sup>2</sup> Tunable White is available in Asymmetric and 20°, 30°, 40°, 55° in Art series.

### CRI

Professional series (P) CRI 90-94 Art series (A) CRI 95-98

### Use with

ZELA adapter plates for retrofit installations

### Driver included – to be specified

Phase cut Dimming  
DALI 2 Tunable White  
DALI 2 Dimming  
SLiC Casambi Tunable White  
SLiC Casambi Dimming



9-36VDC input options available  
Scan the QR code for low voltage driver options

## Product information

**Table is based on:** White, prismatic, 40°, 3000K, CRI 90, phase cut driver  
Contact Switch Lighting for data of other variants

Driver (mA)	Power (W)	Delivered lumens (lm)	Insulation coverable		
			NZ	AU	UK/EU
100	4.3	400	IC-F	IC-4	✓
150	6.4	570	IC-F	IC-4	✓
180	7.7	660	IC-F	IC-4	✓
220	9.4	780	IC-F	IC-4	✓
260	11.1	880	IC-F	IC-4	✓



Tilt Angle 28°



Size 101x58mm



Cut-out Ø83-89mm



Hole depth >63mm\*



Front

\*Specification is for ceiling material ≤ 13mm with a phase cut driver.

## How to specify ZELA Tilt 2

Please confirm model option availability from our website. **Not every combination is compatible.**

e.g. code = **SLDL231T-4030P-TWD11**

Model	Beam	CCT	CRI	Trim Colour	Driver	Market
SLDL234T = Lens	09 = 9° 15 = 15° 20 = 20°	24 = 2400K 27 = 2700K 30 = 3000K 40 = 4000K	P = 90-94 A = 95-98	TW = Textured White TB = Textured Black	<b>Phase cut Dimming</b> D08 = 100mA (4.3W) D09 = 150mA (6.4W) D15 = 180mA (7.7W) D10 = 220mA (9.4W) D11 = 260mA (11.1W) <b>DALI 2 Tunable White</b> D42 = 180mA (8.3W) D43 = 230mA (10.1W) D44 = 260mA (11.9W)	1 = NZ 1 = Aust 2 = UK 3 = EU
SLDL236T = Honeycomb	30 = 30° 40 = 40°	SD = Sunset Dimming S2 = Tunable White			<b>DALI 2 Dimming</b> D02 = 150mA (8.3W) D03 = 200mA (10.1W) D04 = 250mA (11.9W) <b>SLiC Casambi Tunable White</b> D54 = 260mA (11.8W) <b>SLiC Casambi Dimming</b> D57 = 180mA (7.7W) D59 = 260mA (11.1W) <b>Check online for other driver options.</b>	
SLDL230T = Clear glass SLDL231T = Prismatic	40 = 40° 55 = 55°					
SLDL237T = Asymmetric	W3 = 20°x55°					
SLDL233T = Opaque	90 = 90°					

Please see [www.switch-lighting.co.nz](http://www.switch-lighting.co.nz) for full specifications, lux levels, SDoCs, ies files and installation instructions.



**Warranty**  
7yr Luminaire  
5yr Driver

L70 (60,000 h)

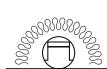

# ZELA *Deep Tilt*



**SLDL224T**  
Lens  
Beam 9° 15° 20°  
Spot lighting



**SLDL227T**  
Asymmetric  
20°x 55°  
Wall washing



**SLDL226T**  
Honeycomb  
30° 40°  
Anti-glare lighting



**SLDL220T**  
Clear glass  
Beam 40° 55°  
Task | General lighting



**SLDL221T**  
Prismatic diffuser  
Beam 40° 55°  
General | Task lighting

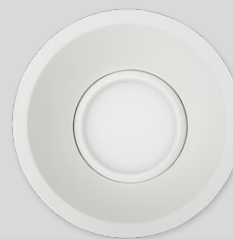

**SLDL223T**  
Opaque diffuser  
Beam 90°  
Wide angle lighting



# ZELA Deep Tilt

- + slim trim for minimalist & modern design, deep recessed for low glare
- + general all purpose luminaire
- + fully adjustable 360° gimbal
- + suitable for indoor use and exterior under soffits
- + IP65 front
- + constant current

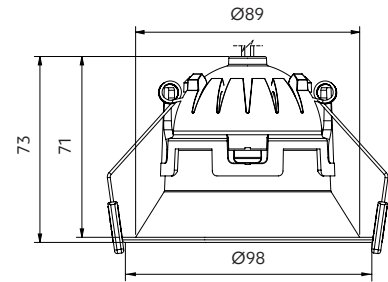

## Options

### Beam angle

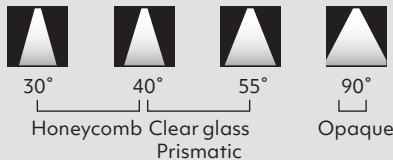

### Trim colour



### CCT



<sup>1</sup> Sunset Dimming is available in 30°, 40° and 55° in Professional series.

<sup>2</sup> Tunable White is available in Asymmetric and 20°, 30°, 40°, 55° in Art series.

### CRI

Professional series (P) CRI 90-94 Art series (A) CRI 95-98

### Use with

ZELA adapter plates for retrofit installations

### Driver included – to be specified

Phase cut Dimming  
 DALI 2 Tunable White  
 DALI 2 Dimming  
 SLiC Casambi Tunable White  
 SLiC Casambi Dimming

9-36VDC input options available

Scan the QR code for low voltage driver options



## Product information

**Table is based on:** White, prismatic, 40°, 3000K, CRI 90, phase cut driver  
Contact Switch Lighting for data of other variants

Driver (mA)	Power (W)	Delivered lumens (lm)	Insulation coverable		
			NZ	AU	UK/EU
150	6.4	590	IC-F	IC-4	✓
180	7.7	690	IC-F	IC-4	✓
220	9.4	810	IC-F	IC-4	✓
260	11.1	920	IC-F	IC-4	✓
300	12.8	1020	CA135	CA90	✓



\*Specification is for ceiling material ≤ 13mm with a phase cut driver.

## How to specify ZELA Deep Tilt

Please confirm model option availability from our website. **Not every combination is compatible.**

e.g. code = **SLDL221T-4030P-TWD11**

Model	Beam	CCT	CRI	Trim Colour	Driver	Market	
SLDL224T = Lens	09 = 9° 15 = 15° 20 = 20°	24 = 2400K 27 = 2700K 30 = 3000K 40 = 4000K	P = 90-94 A = 95-98	TW = Textured White TB = Textured Black	<b>Phase cut Dimming</b> D08 = 100mA (4.3W) D09 = 150mA (6.4W) D15 = 180mA (7.7W) D10 = 220mA (9.4W) D11 = 260mA (11.1W) D12 = 300mA (12.8W) <b>DALI 2 Tunable White</b> D42 = 180mA (8.3W) D43 = 230mA (10.1W) D44 = 260mA (11.9W)	<b>DALI 2 Dimming</b> D02 = 150mA (8.3W) D03 = 200mA (10.1W) D04 = 250mA (11.9W) <b>SLiC Casambi Tunable White</b> D54 = 260mA (11.8W) <b>SLiC Casambi Dimming</b> D57 = 180mA (7.7W) D59 = 260mA (11.8W)	 1 = NZ 2 = AU 3 = UK 3 = EU
SLDL226T = Honeycomb	30 = 30° 40 = 40°	SD = Sunset Dimming S2 = Tunable White					
SLDL220T = Clear glass SLDL221T = Prismatic	40 = 40° 55 = 55°						
SLDL227T = Asymmetric	W3=20°x55°						
SLDL223T = Opaque	90 = 90°						

Please see [www.switch-lighting.co.nz](http://www.switch-lighting.co.nz) for full specifications, lux levels, SDoCs, ies files and installation instructions.



**Warranty**  
7yr Luminaire  
5yr Driver

L70 (60,000 h)

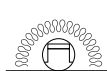

# ZELA *Offset Deep Tilt*



**SLDL254T**  
Lens  
Beam 9° 15° 20°  
Spot lighting



**SLDL257T**  
Asymmetric  
20°x 55°  
Wall washing



**SLDL256T**  
Honeycomb  
30° 40°  
Anti-glare lighting



**SLDL250T**  
Clear glass  
Beam 40° 55°  
Task | General lighting



**SLDL251T**  
Prismatic diffuser  
Beam 40° 55°  
General | Task lighting



**SLDL253T**  
Opaque diffuser  
Beam 90°  
Wide angle lighting

# ZELA Offset Deep Tilt

- + innovative offset design to direct light with precision
- + deep recessed for low glare
- + 360° gimbal, general all purpose luminaire
- + ideal for wall washing, illuminating art and sloped ceilings
- + suitable for indoor use and exterior under soffits
- + IP65 front
- + constant current

Scan to view website

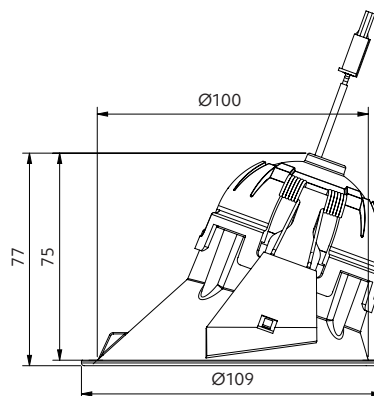

## Options

### Beam angle

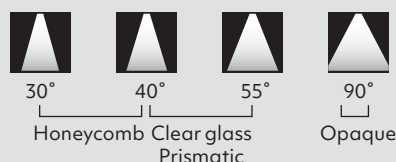

### Trim colour

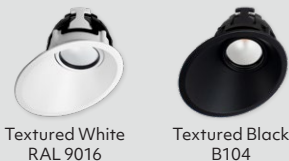

### CCT



<sup>1</sup> Sunset Dimming is available in 30°, 40° and 55° in Professional series.

<sup>2</sup> Tunable White is available in Asymmetric and 20°, 30°, 40°, 55° in Art series.

### CRI

Professional series (P) CRI 90-94 Art series (A) CRI 95-98

### Driver included – to be specified

- Phase cut Dimming
- DALI 2 Tunable White
- DALI 2 Dimming
- SLiC Casambi Tunable White
- SLiC Casambi Dimming

9-36VDC input options available

Scan the QR code for low voltage driver options



## Product information

**Table is based on:** White, prismatic, 40°, 3000K, CRI 90, phase cut driver  
Contact Switch Lighting for data of other variants

Driver (mA)	Power (W)	Delivered lumens (lm)	Insulation coverable		
			NZ	AU	UK/EU
150	6.4	590	IC-F	IC-4	✓
180	7.7	690	IC-F	IC-4	✓
220	9.4	800	IC-F	IC-4	✓
260	11.1	910	IC-F	IC-4	✓
300	12.8	1010	CA135	CA90	✓

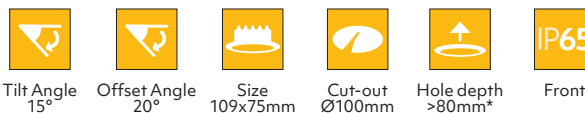

\*Specification is for ceiling material ≤ 13mm with a phase cut driver.

## How to specify ZELA Offset Deep Tilt

Please confirm model option availability from our website. **Not every combination is compatible.**

e.g. code = **SLDL251T-4030P-TWD11**

Model	Beam	CCT	CRI	Trim Colour	Driver	Market
SLDL254T = Lens	09 = 9° 15 = 15° 20 = 20°	24 = 2400K 27 = 2700K 30 = 3000K 40 = 4000K	P = 90-94 A = 95-98	TW = Textured White TB = Textured Black	<b>Phase cut Dimming</b> D08 = 100mA (4.3W) D09 = 150mA (6.4W) D15 = 180mA (7.7W) D10 = 220mA (9.4W) D11 = 260mA (11.1W) D12 = 300mA (12.8W) <b>DALI 2 Tunable White</b> D42 = 180mA (8.3W) D43 = 230mA (10.1W) D44 = 260mA (11.9W)	1 = NZ 2 = UK 3 = EU
SLDL256T = Honeycomb	30 = 30° 40 = 40°	SD = Sunset Dimming S2 = Tunable White			<b>DALI 2 Dimming</b> D02 = 150mA (8.3W) D03 = 200mA (10.1W) D04 = 250mA (11.9W) <b>SLiC Casambi Tunable White</b> D53 = 220mA (10W) <b>SLiC Casambi Dimming</b> D57 = 180mA (7.7W) D58 = 220mA (9.4W) D59 = 260mA (11.8W)	
SLDL250T = Clear glass SLDL251T = Prismatic	40 = 40° 55 = 55°				<b>Check online for other driver options.</b>	
SLDL257T Asymmetric	W3=20°x55°					
SLDL253T = Opaque	90 = 90°					

Please see [www.switch-lighting.co.nz](http://www.switch-lighting.co.nz) for full specifications, lux levels, SDoCs, ies files and installation instructions.



**Warranty**  
7yr Luminaire  
5yr Driver

L70 (60,000 h)

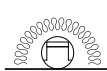

# ZELA Fixed



Merton Suites, Surfers Paradise, Australia



**SLDL214F**  
Lens  
Beam 9° 15° 20°  
Spot lighting



**SLDL217F**  
Asymmetric  
20°x 55°  
Wall washing

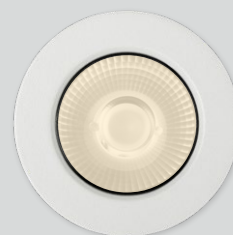

**SLDL216F**  
Honeycomb  
Beam 30° 40°  
Anti-glare lighting



**SLDL212F**  
ULG clear  
Beam 40° 55°  
Task | General lighting

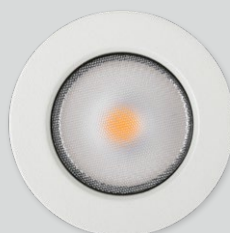

**SLDL211F**  
Prismatic diffuser  
Beam 40° 55°  
General | Task lighting



**SLDL213F**  
Opaque diffuser  
Beam 90°  
Wide angle lighting



# ZELA Fixed

- + enhancing visual appeal with a clean, unobtrusive design
- + feature lighting
- + compact size
- + suitable for indoor use and exterior under soffits
- + IP65 front
- + constant current

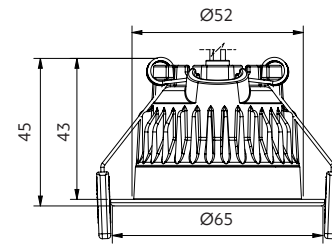

## Options

### Beam angle

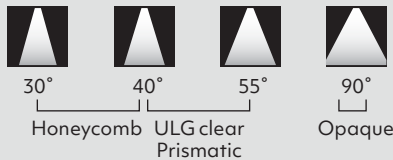

### Trim colour

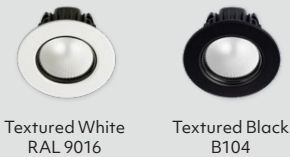

### CCT



<sup>1</sup>Sunset Dimming is available in 30°, 40° and 55° in Professional series.

<sup>2</sup>Tunable White is available in Asymmetric and 20°, 30°, 40°, 55° in Art series.

### CRI

Professional series (P) CRI 90-94 Art series (A) CRI 95-98

### Use with

ZELA adapter plates for retrofit installations

### Driver included – to be specified

Phase cut Dimming  
 DALI 2 Tunable White  
 DALI 2 Dimming  
 SLiC Casambi Tunable White  
 SLiC Casambi Dimming



9-36VDC input options available  
 Scan the QR code for low voltage driver options

## Product information

**Table is based on:** White, prismatic, 40°, 3000K, CRI 90, phase cut driver  
 Contact Switch Lighting for data of other variants

Driver (mA)	Power (W)	Delivered lumens (lm)	Insulation coverable		
			NZ	AU	UK/EU
100	4.3	400	IC-F	IC-4	✓
150	6.4	580	IC-F	IC-4	✓
180	7.7	670	IC-F	IC-4	✓
220	9.4	780	CA135	CA90	✓



\* Specification is for ceiling material ≤ 13mm with a phase cut driver.  
 Required clearance to install driver through Ø52 cut-out.

## How to specify ZELA Fixed

Please confirm model option availability from our website. **Not every combination is compatible.**

e.g. code = **SLDL211F-4030P-TWD15**

Model	Beam	CCT	CRI	Trim Colour	Driver	Market	
SLDL214F = Lens	09 = 9° 15 = 15° 20 = 20°	24 = 2400K 27 = 2700K 30 = 3000K 40 = 4000K	P = 90-94 A = 95-98	TW = Textured White TB = Textured Black	<b>Phase cut</b> D08 = 100mA (4.3W) D09 = 150mA (6.4W) D15 = 180mA (7.7W) D10 = 220mA (9.4W) D11 = 260mA (11.1W) <b>DALI 2 Tunable White</b> D42 = 180mA (8.3W) D43 = 230mA (10.1W) D44 = 260mA (11.9W)	<b>DALI 2 Dimming</b> D02 = 150mA (8.3W) D03 = 200mA (10.1W) D04 = 250mA (11.9W) <b>SLiC Casambi Tunable White</b> D51 = 150mA (6.8W) <b>SLiC Casambi Dimming</b> D56 = 150mA (6.4W) D57 = 180mA (7.7W) <b>Check online for other driver options.</b>	1 = NZ 1 = Aust 2 = UK 3 = EU
SLDL216F = Honeycomb	30 = 30° 40 = 40°	SD = Sunset Dimming S2 = Tunable White					
SLDL212F = ULG clear glass SLDL211F = Prismatic	40 = 40° 55 = 55°						
SLDL217F Asymmetric	W3=20°x55°						
SLDL213F = Opaque	90 = 90°						

Please see [www.switch-lighting.co.nz](http://www.switch-lighting.co.nz) for full specifications, lux levels, SDoCs, ies files and installation instructions.



**Warranty**  
7yr Luminaire  
5yr Driver

L70 (60,000 h)

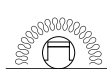

# ZELA Deep Fixed



Nelson private residence  
Mado Architects | Tasman Sparkies



**SLDL224F**  
Lens  
Beam 9° 15° 20°  
Spot lighting



**SLDL227F**  
Asymmetric  
20°x 55°  
Wall washing



**SLDL226F**  
Honeycomb  
Beam 30° 40°  
Anti-glare lighting



**SLDL220F**  
Clear glass  
Beam 40° 55°  
Task | General lighting



**SLDL221F**  
Prismatic  
Beam 40° 55°  
General | Task lighting

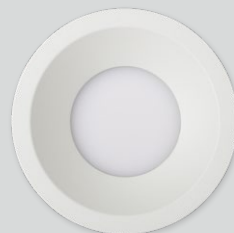

**SLDL223F**  
Opaque  
Beam 90°  
Wide angle lighting



# ZELA Deep Fixed

- + stylish and unobtrusive design, deep recessed for low glare
- + general all purpose luminaire
- + suitable for indoor use and exterior under soffits
- + IP65 front
- + constant current

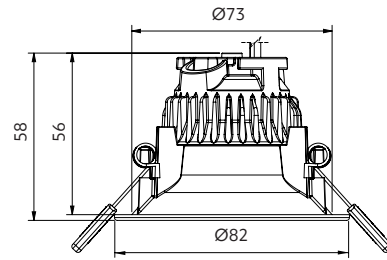

## Options

### Beam angle

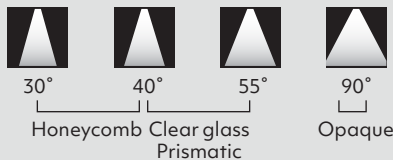

### Trim colour



### CCT



<sup>1</sup> Sunset Dimming is available in 30°, 40° and 55° in Professional series.

<sup>2</sup> Tunable White is available in Asymmetric and 20°, 30°, 40°, 55° in Art series.

### CRI

Professional series (P) CRI 90-94 Art series (A) CRI 95-98

### Use with

ZELA adapter plates for retrofit installations

### Driver included – to be specified

Phase cut Dimming  
 DALI 2 Tunable White  
 DALI 2 Dimming  
 SLiC Casambi Tunable White  
 SLiC Casambi Dimming

9-36VDC input options available

Scan the QR code for low voltage driver options



## Product information

**Table is based on:** White, prismatic, 40°, 3000K, CRI 90, phase cut driver

Contact Switch Lighting for data of other variants

Driver (mA)	Power (W)	Delivered lumens (lm)	Insulation coverable		
			NZ	AU	UK/EU
100	4.3	410	IC-F	IC-4	✓
150	6.4	580	IC-F	IC-4	✓
180	7.7	680	IC-F	IC-4	✓
220	9.4	790	IC-F	IC-4	✓
260	11.1	880	CA135	CA90	✓



Size 82x56mm



Cut-out Ø73mm



Hole depth >67mm\*



Front

\*Specification is for ceiling material ≤ 13mm with a phase cut driver.

## How to specify ZELA Deep Fixed

Please confirm model option availability from our website. **Not every combination is compatible.**

e.g. code = **SLDL221F-4030P-TWD10**

Model	Beam	CCT	CRI	Trim Colour	Driver	Market
SLDL224F = Lens	09 = 9° 15 = 15° 20 = 20°	24 = 2400K 27 = 2700K 30 = 3000K 40 = 4000K	P = 90-94 A = 95-98	TW = Textured White TB = Textured Black	<b>Phase cut Dimming</b> D08 = 100mA (4.3W) D09 = 150mA (6.4W) D15 = 180mA (7.7W) D10 = 220mA (9.4W) D11 = 260mA (11.1W) <b>DALI 2 Tunable White</b> D42 = 180mA (8.3W) D43 = 230mA (10.1W) D44 = 260mA (11.9W)	1 = NZ 1 = Aust 2 = UK 3 = EU
SLDL226F = Honeycomb	30 = 30° 40 = 40°	SD = Sunset Dimming S2 = Tunable White			<b>DALI 2 Dimming</b> D02 = 150mA (8.3W) D03 = 200mA (10.1W) D04 = 250mA (11.9W) <b>SLiC Casambi Tunable White</b> D52 = 180mA (8.2W) <b>SLiC Casambi Dimming</b> D57 = 180mA (7.7W) D58 = 220mA (9.4W) <b>Check online for other driver options.</b>	
SLDL220F = Clear glass SLDL221F = Prismatic	40 = 40° 55 = 55°					
SLDL227F = Asymmetric	W3=20°x55°					
SLDL223F = Opaque	90 = 90°					

Please see [www.switch-lighting.co.nz](http://www.switch-lighting.co.nz) for full specifications, lux levels, SDoCs, ies files and installation instructions.



**Warranty**  
7yr Luminaire  
5yr Driver

L70 (60,000 h)

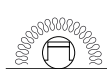

# ZELA Fixed 1 décor



Wanaka private residence  
My Local Electrician



**SLDL284F**  
Beam 9°, 15°, 20°



**SLDL280F**  
Beam 30°, 40°



Black inner  
Textured Black  
BB



Gold inner  
Textured Black  
AB



Bronze inner  
Textured Black  
DB

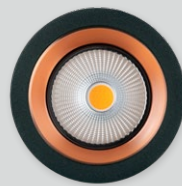

Copper inner  
Textured Black  
CB



White inner  
Textured Black  
WB



Black inner  
Textured White  
BW



Gold inner  
Textured White  
AW



Bronze inner  
Textured White  
DW



Copper inner  
Textured White  
CW



White inner  
Textured White  
WW



# ZELA décor Fixed 1

- + create artistic ambiance & visual intrigue
- + feature lighting
- + deep recessed for low glare
- + attractive colour options for inner
- + IP65 front
- + constant current

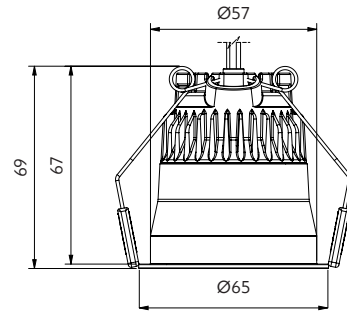

## Options

### Beam angle



### CCT



<sup>1</sup> Sunset Dimming is available in 30°, 40° and 55° in Professional series.

<sup>2</sup> Tunable White is available in Asymmetric and 20°, 30°, 40°, 55° in Art series.

### Trim colour

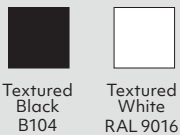

### Inner colour

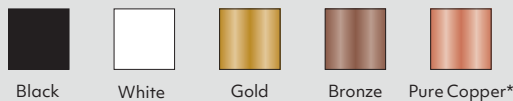

\*Our copper variant is true copper and may contain small natural flaws. Over time, it will develop verdigris, darkening in colour to a variety of rich tones. This process will be slower in areas where the fitting is not exposed to moisture.

### CRI

Professional series (P) CRI 90-94 Art series (A) CRI 95-98

### Driver included – to be specified

- Phase cut Dimming
- DALI 2 Tunable White
- DALI 2 Dimming
- SLiC Casambi Tunable White
- SLiC Casambi Dimming



9-36VDC input options available  
Scan the QR code for low voltage driver options

## Product information

**Table is based on:** White, prismatic, 40°, 3000K, CRI 90, phase cut driver  
Contact Switch Lighting for data of other variants

Driver (mA)	Power (W)	Delivered lumens (lm)	Insulation coverable		
			NZ	AU	UK/EU
100	4.3	310	IC-F	IC-4	✓
150	6.4	440	IC-F	IC-4	✓
180	7.7	510	IC-F	IC-4	✓
220	9.4	600	CA135	CA90	✓
260	11.1	680	Do not cover		



\* Specification is for ceiling material ≤ 13mm with a phase cut driver. Required clearance to install driver through Ø57 cut-out.

## How to specify ZELA décor Fixed 1

Please confirm model option availability from our website. **Not every combination is compatible.**

e.g. code = **SLDL280F-4030P-DWD15**

Model	Beam	CCT	CRI	Colour - Inner / Trim	Driver	Market
SLDL284F = Lens	09 = 9° 15 = 15° 20 = 20°	24 = 2400K 27 = 2700K 30 = 3000K 40 = 4000K	P = 90-94 A = 95-98	AW = Gold / White BW = Black / White CW = Copper / White DW = Bronze / White WW = White / White AB = Gold / Black BB = Black / Black DB = Bronze / Black CB = Copper / Black WB = White / Black	<b>Phase cut Dimming</b> D08 = 100mA (4.3W) D09 = 150mA (6.4W) D15 = 180mA (7.7W) D10 = 220mA (9.4W) D11 = 260mA (11.1W) <b>DALI 2 Tunable White</b> D42 = 180mA (8.3W) D43 = 230mA (10.1W) D44 = 260mA (11.9W)	<ul style="list-style-type: none"> <li>1 = NZ</li> <li>1 = Aust</li> <li>2 = UK</li> <li>3 = EU</li> </ul>
SLDL280F = Clear glass	30 = 30° 40 = 40°	SD = Sunset Dimming S2 = Tunable White			<b>DALI 2 Dimming</b> D02 = 150mA (8.3W) D03 = 200mA (10.1W) D04 = 250mA (11.9W) <b>SLiC Casambi Tunable White</b> D52 = 180mA (8.2W) <b>SLiC Casambi Dimming</b> D57 = 180mA (7.7W) <b>Check online for other driver options.</b>	

Please see [www.switch-lighting.co.nz](http://www.switch-lighting.co.nz) for full specifications, lux levels, SDoCs, ies files and installation instructions.



**Warranty**  
7yr Luminaire  
5yr Driver

L70 (60,000 h)

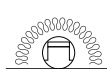

# ZELA Surface Mount Fixed 1

décor

Christchurch private residence, Inception Electrical



Gold inner



Copper inner



Bronze inner



White inner



Black inner



These inners can be combined with Textured Black or Textured White trims

**SLSM101F**  
Beam 40° 55°



**SLSM104F**  
Lens  
Beam 9° 15° 20°  
Spot lighting



**SLSM103F**  
Opaque  
Beam 90°  
Wide angle lighting



**SLSM106F**  
Honeycomb  
Beam 30° 40°  
Anti-glare lighting



**SLSM100F**  
Clear glass  
Beam 40° 55°  
Task | General lighting



**SLSM101F**  
Prismatic  
Beam 40° 55°  
General | Task lighting

# ZELA décor Surface Mount Fixed 1

- + a captivating and eye-catching design, recessed for low glare
- + attractive colour options for inner
- + IP20
- + constant current

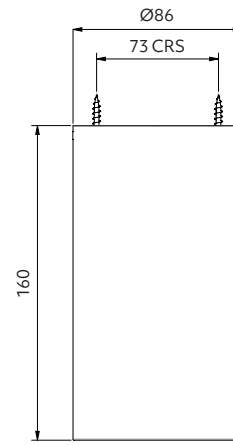

Scan to view website

## Options

### Beam angle

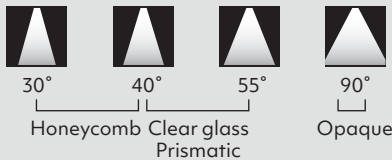
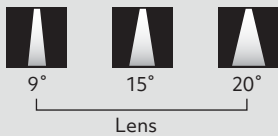

### Trim colour

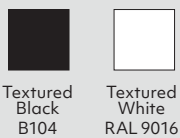

### Inner colour



### CCT

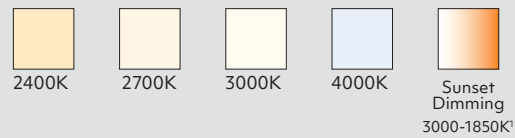

<sup>1</sup>Sunset Dimming is available in 30°, 40° and 55° in Professional series.

### CRI

Professional series (P) CRI 90-94 Art series (A) CRI 95-98

### Driver included – to be specified

Phase cut Dimming  
DALI 2 Tunable White  
DALI 2 Dimming  
SLiC Casambi Tunable White  
SLiC Casambi Dimming



9-36VDC input options available  
Scan the QR code for low voltage driver options

## Product information

**Table is based on:** White, clear glass, 40°, 3000K, CRI 90, phase cut driver  
Contact Switch Lighting for data of other variants

Driver (mA)	Power (W)	Delivered lumens (lm)
150	6.4	580
260	11.1	900



Size  
86x160mm

## How to specify ZELA décor Surface Mount Fixed 1

Please confirm model option availability from our website. **Not every combination is compatible.**

e.g. code = **SLSM101F-4030P-BWD45**

Model	Beam	CCT	CRI	Colour - Inner / Trim	Driver - Phase cut	Market
SLSM104F = Lens	09 = 9° 15 = 15° 20 = 20°	24 = 2400K 27 = 2700K <b>30</b> = 3000K 40 = 4000K SD = Sunset Dimming	<b>P</b> = 90-94 A = 95-98	AW = Gold / White <b>BW</b> = Black / White CW = Copper / White DW = Bronze / White WW = White / White AB = Gold / Black BB = Black / Black CB = Copper / Black DB = Bronze / Black WB = White / Black	<b>D45</b> = 150mA (6.4W) D46 = 260mA (11.1W)  <b>Contact Switch Lighting for other options</b>	<b>I</b> = NZ 1 = Aust 2 = UK 3 = EU
SLSM106F = Honeycomb	30 = 30° 40 = 40°					
SLSM100F = Clear glass <b>SLSM101F</b> = Prismatic	<b>40</b> = 40° 55 = 55°					
SLSM103F = Opaque	90 = 90°					

Please see [www.switch-lighting.co.nz](http://www.switch-lighting.co.nz) for full specifications, lux levels, SDoCs, ies files and installation instructions.



**Warranty**  
7yr Luminaire  
5yr Driver

L70 (60,000 h)



# ZELA Pendant 1

décor



SLPN100F  
Beam 40° 55°

Gold inner



Copper inner



Bronze inner



White inner



Black inner



SLPN104F  
Lens  
Beam 9° 15° 20°  
Spot lighting



SLPN106F  
Honeycomb  
Beam 30° 40°  
Anti-glare lighting



SLPN100F  
Clear glass  
Beam 40° 55°  
Task | General lighting



SLPN101F  
Prismatic  
Beam 40° 55°  
General | Task lighting

# ZELA décor Pendant 1

- + add a touch of sophistication and visual intrigue
- + slim ceiling rose design
- + adjustable cable length
- + attractive colour options for inner
- + tunable white option
- + IP20
- + constant current

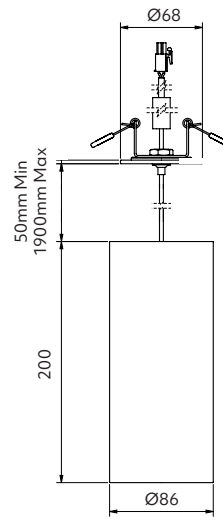

Scan to view website



## Options

### Beam angle

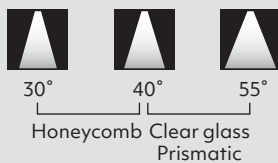

### Trim colour

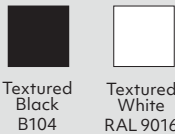

### Inner colour



### CCT



<sup>1</sup> Sunset Dimming is available in 30°, 40° and 55° in Professional series.  
<sup>2</sup> Tunable White is available in 20°, 30°, 40°, 55° in Art series.

### CRI

Professional series (P) CRI 90-94 Art series (A) CRI 95-98

### Driver included – to be specified

Phase cut Dimming  
 DALI 2 Dimming  
 SLiC Casambi Tunable White  
 SLiC Casambi Dimming

Driver installed in ceiling behind ceiling rose.

9-36VDC input options available  
 Scan the QR code for low voltage driver options



## Product information

**Table is based on:** White, prismatic, 55°, 3000K, CRI 90, phase cut driver  
 Contact Switch Lighting for data of other variants

Driver (mA)	Power (W)	Delivered lumens (lm)
180	8.3	470 (9° only)
260	11.1	880

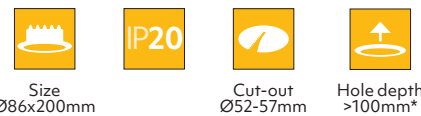

\* Specification is for ceiling material ≤ 13mm with a phase cut driver.  
 Required clearance to install driver through Ø52 cut-out.

## How to specify ZELA décor Pendant 1

Please confirm model option availability from our website. **Not every combination is compatible.**

e.g. code = **SLPN101F-5530P-BWD11**

Model	Beam	CCT	CRI	Colour - Inner / Trim	Driver	Market
SLPN104F = Lens	09 = 9° 15 = 15° 20 = 20°	24 = 2400K 27 = 2700K 30 = 3000K 40 = 4000K	P = 90-94 A = 95-98	AW = Gold / White BW = Black / White CW = Copper / White DW = Bronze / White WW = White / White AB = Gold / Black BB = Black / Black CB = Copper / Black DB = Bronze / Black WB = White / Black	<b>Phase cut Dimming</b> D15 = 180mA (8.3W) D11 = 260mA (11.1W) <b>DALI 2 Dimming</b> D02 = 150mA (8.3W) D04 = 250mA (11.9W) <b>SLiC Casambi Tunable White</b> D54 = 260mA (11.8W) <b>SLiC Casambi Dimming</b> D57 = 180mA (7.7W) D59 = 260mA (11.8W) <b>Check online for other driver options.</b>	1 = NZ 2 = Aust 3 = EU
SLPN106F = Honeycomb	30 = 30° 40 = 40°	SD = Sunset Dimming S2 = Tunable White				
SLPN100F = Clear glass SLPN101F = Prismatic	40 = 40° 55 = 55°					

Please see [www.switch-lighting.co.nz](http://www.switch-lighting.co.nz) for full specifications, lux levels, SDoCs, ies files and installation instructions.



**Warranty**  
 7yr Luminaire  
 5yr Driver

L70 (60,000h)

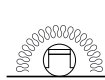

CONSTANT  
**CC**  
 CURRENT



# ZELA Art Spot



**SLAS214T**  
Lens  
Beam 9° 15° 20°



**SLAS216T**  
Honeycomb  
Beam 30° 40°



**SLAS212T**  
ULG Clear  
Beam 40° 55°



**SLAS211T**  
Prismatic  
Beam 40° 55°



**SLAS213T**  
Opaque  
Beam 90°



**SLAS217T**  
Asymmetric  
Beam 20°x 55°



# ZELA Art Spot

- + low glare semi-recessed spot light with a stylish and modern design
- + general all purpose luminaire
- + art spot light, perfect for galleries, hallways
- + suitable for indoor use
- + 350° pan rotation | 95° tilt rotation
- + constant current

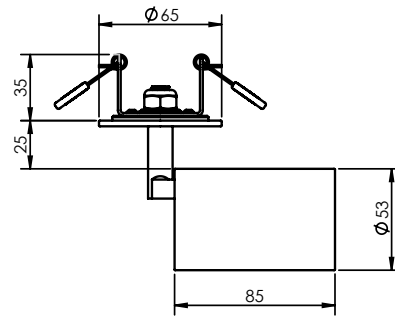

## Options

### Beam angle

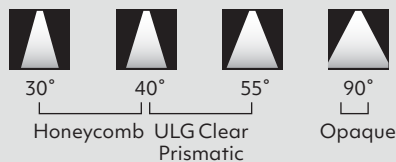

### Trim colour

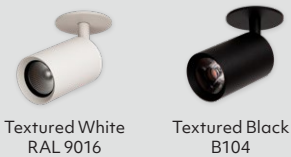

### CCT



<sup>1</sup> Sunset Dimming is available in 30°, 40° and 55° in Professional series.

<sup>2</sup> Tunable White is available in Asymmetric and 20°, 30°, 40°, 55° in Art series.

### CRI

Professional series (P) CRI 90-94 Art series (A) CRI 95-98

### Driver included – to be specified

Phase cut Dimming  
DALI 2 Tunable White  
DALI 2 Dimming  
SLiC Casambi Tunable White  
SLiC Casambi Dimming

9-36VDC input options available  
Scan the QR code for low voltage driver options



## Product information

**Table is based on:** White, prismatic, 40°, 3000K, CRI 90, phase cut driver  
Contact Switch Lighting for data of other variants

Driver (mA)	Power (W)	Delivered lumens (lm)	Insulation coverable		
			NZ	AU	UK/EU
260	11.1	880	IC-F	IC-4	✓



Size  
Ø53x85mm



Cut-out  
Ø52-56mm



Hole depth  
>100mm\*



IP20

\* Specification is for ceiling material ≤ 13mm with a phase cut driver.  
Required clearance to install driver through Ø52 cut-out.

## How to specify ZELA Art Spot

Please confirm model option availability from our website. **Not every combination is compatible.**

e.g. code = **SLAS211T-4030P-TWD11**

Model	Beam	CCT	CRI	Trim Colour	Driver	Market	
SLAS214T = Lens	09 = 9° 15 = 15° 20 = 20°	24 = 2400K 27 = 2700K <b>30</b> = 3000K 40 = 4000K	<b>P</b> = 90-94 A = 95-98	<b>TW</b> = Textured White TB = Textured Black	<b>Phase cut Dimming</b> D15 = 180mA (7.7W) <sup>3</sup> <b>D11</b> = 260mA (11.1W) <b>DALI 2 Tunable White</b> D44 = 260mA (11.9W) <b>DALI 2 Dimming</b> D02 = 150mA (8.3W) <sup>3</sup> D04 = 250mA (11.9W)	<b>SLiC Casambi Tunable White</b> D59 = 260mA (11.1W) <b>SLiC Casambi Dimming</b> D57 = 180mA (7.7W) <sup>3</sup> D54 = 260mA (11.1W) <b>Check online for other driver options.</b>	<b>1</b> = NZ 1 = Aust 2 = UK 3 = EU
SLAS216T = Honeycomb	30 = 30° 40 = 40°	SD = Sunset Dimming S2 = Tunable White					
SLAS212T = ULG Clear <b>SLAS211T</b> = Prismatic	<b>40</b> = 40° 55 = 55°						
SLAS217T = Asymmetric	W3 = 20° x 55°						
SLAS213T = Opaque	90 = 90°						

<sup>3</sup>Power option available for 9° only

Please see [www.switch-lighting.co.nz](http://www.switch-lighting.co.nz) for full specifications, lux levels, SDcCs, ies files and installation instructions.



**Warranty**  
7yr Luminaire  
5yr Driver

L70 (60,000 h)

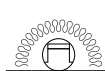

# ZELA *Fire Rated Tilt*



**SLDF244T**  
Lens  
9° 15° 20°  
Spot lighting

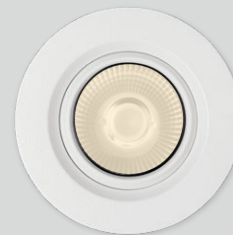

**SLDF247T**  
Asymmetric  
20°x 55°  
Wall washing



**SLDF246T**  
Honeycomb  
30° 40°  
Anti-glare lighting



**SLDF242T**  
ULG clear  
40° 55°  
Task | General lighting



**SLDF241T**  
Prismatic diffuser  
40° 55°  
General | Task lighting

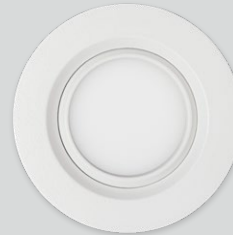

**SLDF243T**  
Opaque diffuser  
90°  
Wide angle lighting



# ZELA Fire Rated Tilt

- + seamlessly combine fire safety with contemporary aesthetics
- + BRANZ approved for GIB systems
- + fully adjustable 360° gimbal
- + IP65 front
- + constant current

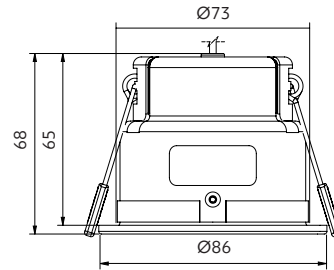

## Options

### Beam angle

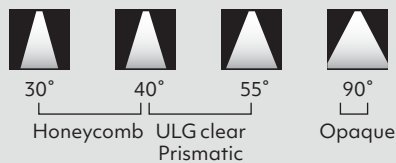

### Trim colour



### CCT

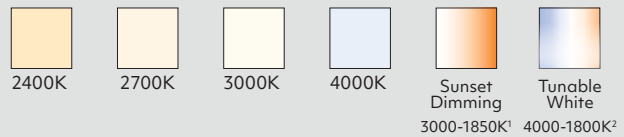

<sup>1</sup> Sunset Dimming is available in 30°, 40° and 55° in Professional series.

<sup>2</sup> Tunable White is available in Asymmetric and 20°, 30°, 40°, 55° in Art series.

### CRI

Professional series (P) CRI 90-94 Art series (A) CRI 95-98

### Driver included – to be specified

Phase cut Dimming  
 DALI 2 Tunable White  
 DALI 2 Dimming  
 SLiC Casambi Tunable White  
 SLiC Casambi Dimming

9-36VDC input options available

Scan the QR code for low voltage driver options



## Product information

**Table is based on:** White, prismatic, 40°, 3000K, CRI 90, phase cut driver  
Contact Switch Lighting for data of other variants

Driver (mA)	Power (W)	Delivered lumens (lm)	Insulation coverable		
			NZ	AU	UK/EU
100	4.3	420	IC-F	IC-4	✓
150	6.4	590	IC-F	IC-4	✓
180	7.7	690	IC-F	IC-4	✓
220	9.4	810	IC-F	IC-4	✓
260	11.1	920	CA135	CA90	✓



Tilt Angle  
28°



Size  
86x65mm



Cut-out  
Ø73mm



Cavity depth  
>190mm\*



Front

\*Fire Rated downlights must not be installed into a cavity of less than 190mm as tested to AS 1530.4:2014  
Refer to our website for Technical Opinion Summary on approved systems.

## How to specify ZELA Fire Rated Tilt

Please confirm model option availability from our website. **Not every combination is compatible.**

e.g. code = **SLDF241T-4030P-TWD10**

Model	Beam	CCT	CRI	Trim Colour	Driver	Market	
SLDF244T = Lens	09 = 9° 15 = 15° 20 = 20°	24 = 2400K 27 = 2700K <b>30</b> = 3000K 40 = 4000K	<b>P</b> = 90-94 A = 95-98	<b>TW</b> = Textured White TB = Textured Black	<b>Phase cut Dimming</b> D08 = 100mA (4.3W) D09 = 150mA (6.4W) D15 = 180mA (7.7W) <b>D10</b> = 220mA (9.4W) D11 = 260mA (11.1W) <b>DALI 2 Tunable White</b> D42 = 180mA (8.3W) D43 = 230mA (10.1W) D44 = 260mA (11.9W)	<b>DALI 2 Dimming</b> D02 = 150mA (8.3W) D03 = 200mA (10.1W) D04 = 250mA (11.9W) <b>SLiC Casambi Tunable White</b> D53 = 220mA (10W) <b>SLiC Casambi Dimming</b> D57 = 180mA (7.7W) D58 = 220mA (9.4W)	<b>1</b> = NZ <b>1</b> = Aust <b>2</b> = UK <b>3</b> = EU
SLDF246T = Honeycomb	30 = 30° 40 = 40°	SD = Sunset Dimming S2 = Tunable White					
SLDF242T = ULG clear glass <b>SLDF241T</b> = Prismatic	<b>40</b> = 40° 55 = 55°						
SLDF247T = Asymmetric	W3 = 20°x 55°						
SLDF243T = Opaque	90 = 90°						

Please see [www.switch-lighting.co.nz](http://www.switch-lighting.co.nz) for full specifications, lux levels, SDoCs, ies files and installation instructions.



**Warranty**  
7yr Luminaire  
5yr Driver

L70 (60,000 h)

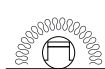

# ZELA Fire Rated Fixed

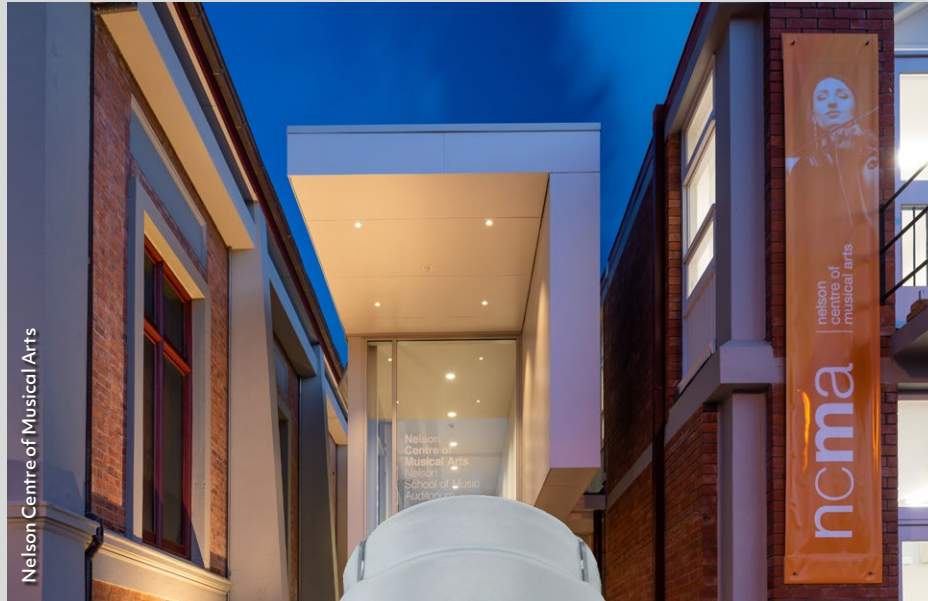

Nelson Centre of Musical Arts



**SLDF244F**  
Lens  
Beam 9° 15° 20°  
Spot lighting

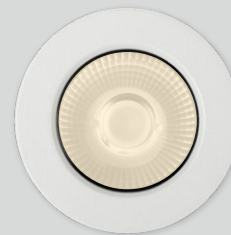

**SLDF247F**  
Asymmetric  
20°x55°  
Wall washing



**SLDF246F**  
Honeycomb  
Beam 30° 40°  
Anti-glare lighting



**SLDF242F**  
ULG clear  
Beam 40° 55°  
Task | General lighting

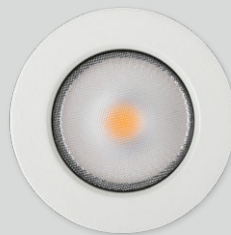

**SLDF241F**  
Prismatic diffuser  
Beam 40° 55°  
General | Task lighting

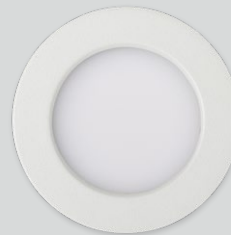

**SLDF243F**  
Opaque diffuser  
Beam 90°  
Wide angle lighting



# ZELA Fire Rated Fixed

- + maintain a stylish and modern appearance
- + BRANZ approved for GIB fire systems
- + compact size
- + IP65 front
- + constant current

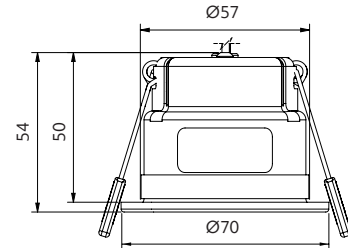

## Options

### Beam angle

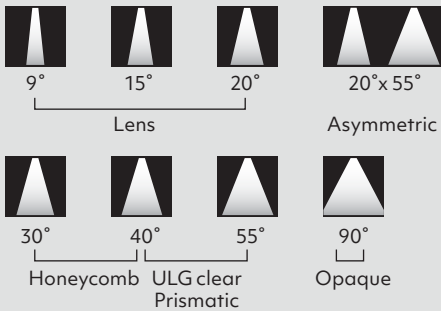

### Trim colour



### CCT



<sup>1</sup> Sunset Dimming is available in 30°, 40° and 55° in Professional series.  
<sup>2</sup> Tunable White is available in Asymmetric and 20°, 30°, 40°, 55° in Art series.

### CRI

Professional series (P) CRI 90-94 Art series (A) CRI 95-98

### Driver included – to be specified

- Phase cut Dimming
- DALI 2 Tunable White
- DALI 2 Dimming
- SLiC Casambi Tunable White
- SLiC Casambi Dimming



9-36VDC input options available  
 Scan the QR code for low voltage driver options

## Product information

**Table is based on:** White, prismatic, 40°, 3000K, CRI 90, phase cut driver  
 Contact Switch Lighting for data of other variants

Driver (mA)	Power (W)	Delivered lumens (lm)	Insulation coverable		
			NZ	AU	UK/EU
100	4.3	420	IC-F	IC-4	✓
150	6.4	590	IC-F	IC-4	✓
180	7.7	690	IC-F	IC-4	✓
220	9.4	810	CA135	CA90	✓
260	11.1	920	Do not cover		



\*Fire Rated downlights must not be installed into a cavity of less than 190mm as tested to AS 1530.4:2014  
 Refer to our website for Technical Opinion Summary on approved systems.

## How to specify ZELA Fire Rated Fixed

Please confirm model option availability from our website. **Not every combination is compatible.**

e.g. code = **SLDF241F-4030P-TWD15**

Model	Beam	CCT	CRI	Trim Colour	Driver	Market
SLDF244F = Lens	09 = 9° 15 = 15° 20 = 20°	24 = 2400K 27 = 2700K 30 = 3000K 40 = 4000K	P = 90-94 A = 95-98	TW = Textured White TB = Textured Black	<b>Phase cut Dimming</b> D08 = 100mA (4.3W) D09 = 150mA (6.4W) D15 = 180mA (7.7W) D10 = 220mA (9.4W) D11 = 260mA (11.1W) <b>DALI 2 Tunable White</b> D42 = 180mA (8.3W) D43 = 230mA (10.1W) D44 = 260mA (11.9W)	1 = NZ 1 = Aust 2 = UK 3 = EU
SLDF246F = Honeycomb	30 = 30° 40 = 40°	SD = Sunset Dimming S2 = Tunable White			<b>DALI 2 Dimming</b> D02 = 150mA (8.3W) D03 = 200mA (10.1W) D04 = 250mA (11.9W) <b>SLiC Casambi Tunable White</b> D52 = 180mA (8.2W) <b>SLiC Casambi Dimming</b> D57 = 180mA (7.7W) D58 = 220mA (9.4W)	
SLDF242F = ULG clear glass SLDF241F = Prismatic	40 = 40° 55 = 55°				<b>Check online for other driver options.</b>	
SLDF247F = Asymmetric	W3 = 20° x 55°					
SLDF243F = Opaque	90 = 90°					

Please see [www.switch-lighting.co.nz](http://www.switch-lighting.co.nz) for full specifications, lux levels, SDcCs, ies files and installation instructions.



**Warranty**  
 7yr Luminaire  
 5yr Driver

L70 (60,000h)

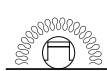

# ZELA Fire Rated Deep Fixed



Tiny Greenie, Golden Bay Hideaway



**SLDF274F**  
Lens  
Beam 9° 15° 20°  
Spot lighting

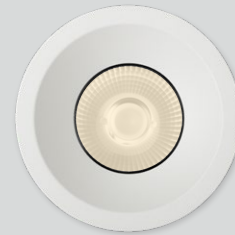

**SLDF277F**  
Asymmetric  
20°x 55°  
Wall washing



**SLDF276F**  
Honeycomb  
Beam 30° 40°  
Anti-glare lighting



**SLDF270F**  
Clear glass  
Beam 40° 55°  
Task | General lighting



**SLDF271F**  
Prismatic  
Beam 40° 55°  
General | Task lighting

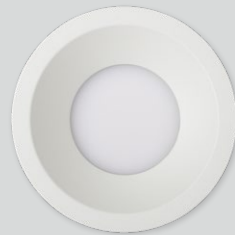

**SLDF273F**  
Opaque  
Beam 90°  
Wide angle lighting



# ZELA Fire Rated Deep Fixed

- + a visually pleasing choice for both safety and style
- + BRANZ approved for GIB fire systems
- + recessed for low glare
- + excellent beam designs
- + IP65 front
- + constant current

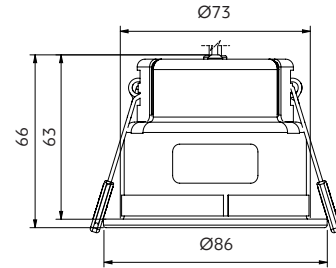

## Options

### Beam angle

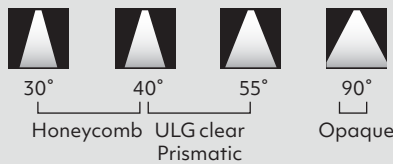

### Trim colour



### CCT



<sup>1</sup> Sunset Dimming is available in 30°, 40° and 55° in Professional series.  
<sup>2</sup> Tunable White is available in 20°, 30°, 40°, and 55° in Art series.

### CRI

Professional series (P) CRI 90-94 Art series (A) CRI 95-98

### Driver included – to be specified

- Phase cut Dimming
- DALI 2 Tunable White
- DALI 2 Dimming
- SLiC Casambi Tunable White
- SLiC Casambi Dimming

9-36VDC input options available  
 Scan the QR code for low voltage driver options



## Product information

**Table is based on:** White, prismatic, 40°, 3000K, CRI 90, phase cut driver  
 Contact Switch Lighting for data of other variants

Driver (mA)	Power (W)	Delivered lumens (lm)	Insulation coverable		
			NZ	AU	UK/EU
100	4.3	420	IC-F	IC-4	✓
150	6.4	590	IC-F	IC-4	✓
180	7.7	690	IC-F	IC-4	✓
220	9.4	810	IC-F	IC-4	✓
260	11.1	920	CA135	CA90	✓

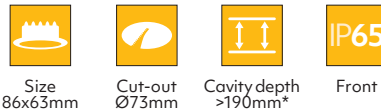

\*Fire Rated downlights must not be installed into a cavity of less than 190mm as tested to AS 1530.4:2014  
 Refer to our website for Technical Opinion Summary on approved systems.

## How to specify ZELA Fire Rated Deep Fixed

Please confirm model option availability from our website. **Not every combination is compatible.**

e.g. code = **SLDF271F-4030P-TWD10**

Model	Beam	CCT	CRI	Trim Colour	Driver	Market
SLDF274F = Lens	09 = 9° 15 = 15° 20 = 20°	24 = 2400K 27 = 2700K 30 = 3000K 40 = 4000K	P = 90-94 A = 95-98	TW = Textured White TB = Textured Black	<b>Phase cut Dimming</b> D08 = 100mA (4.3W) D09 = 150mA (6.4W) D15 = 180mA (7.7W) D10 = 220mA (9.4W) D11 = 260mA (11.1W) <b>DALI 2 Tunable White</b> D42 = 180mA (8.3W) D43 = 230mA (10.1W) D44 = 260mA (11.9W)	1 = NZ 2 = UK 3 = EU
SLDF276F = Honeycomb	30 = 30° 40 = 40°	SD = Sunset Dimming S2 = Tunable White			<b>DALI 2 Dimming</b> D02 = 150mA (8.3W) D03 = 200mA (10.1W) D04 = 250mA (11.9W) <b>SLiC Casambi Tunable White</b> D53 = 220mA (10W) <b>SLiC Casambi Dimming</b> D57 = 180mA (7.7W) D58 = 220mA (9.4W) <b>Check online for other driver options.</b>	
SLDF270F = Clear glass SLDF271F = Prismatic	40 = 40° 55 = 55°					
SLDF277F = Asymmetric	W3 = 20°x55°					
SLDF273F = Opaque						

Please see [www.switch-lighting.co.nz](http://www.switch-lighting.co.nz) for full specifications, lux levels, SDCs, ies files and installation instructions.



**Warranty**  
 7yr Luminaire  
 5yr Driver

L70 (60,000 h)

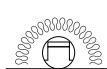

# ZELA Adapter Plates



## ZELA Tilt / Deep Fixed

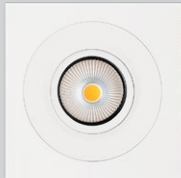

SLSUP-82-S-TW

105mm single square  
(Ø89-99mm cut-out)

SLSUP-82-S-TB  
SLSUP-82-S-TW

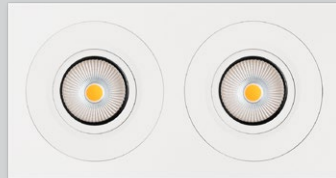

SLSUP-82-D-TW

105 x 200mm double rectangular  
(2 x Ø89-99mm cut-out)

SLSUP-82-D-TB  
SLSUP-82-D-TW



SLSUP-82-T-TW

105 x 295mm triple rectangular  
(3 x Ø89-99mm cut-out)

SLSUP-82-T-TB  
SLSUP-82-T-TW

## ZELA Tilt / Deep Fixed



SLSUP-82-100-TW

100mm diameter  
(Ø89-95mm cut-out)

SLSUP-82-100-TB  
SLSUP-82-100-TW

## ZELA Fixed

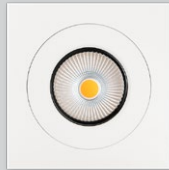

SLSUP-65-S-TW

87mm single square  
(Ø70-79mm cut-out)

SLSUP-65-S-TB  
SLSUP-65-S-TW

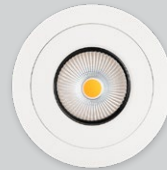

SLSUP-65-87-TW

87mm diameter  
(Ø70-79mm cut-out)

SLSUP-65-87-TB  
SLSUP-65-87-TW

## ZELA Deep Tilt



SLSUP-98-120-TW

120mm diameter  
(Ø89-111mm cut-out)

SLSUP-98-120-TB  
SLSUP-98-120-TW

## ZELA Tilt 2



SLSUP-101-S-TW

122mm single square  
(Ø108-114mm cut-out)

SLSUP-101-S-TB  
SLSUP-101-S-TW

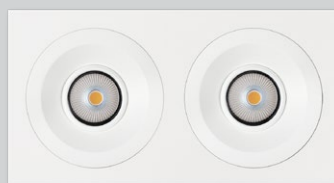

SLSUP-101-D-TW

122 x 233mm double rectangular  
(2 x Ø108-114mm cut-out)

SLSUP-101-D-TB  
SLSUP-101-D-TW



SLSUP-101-120-TW

120mm diameter  
(Ø83-111mm cut-out)

SLSUP-101-120-TB  
SLSUP-101-120-TW

### Trim colour



Textured White  
RAL 9016



Textured Black  
B104

Scan to view  
website



All luminaires ordered separately