

# ZELA Fire Rated Fixed

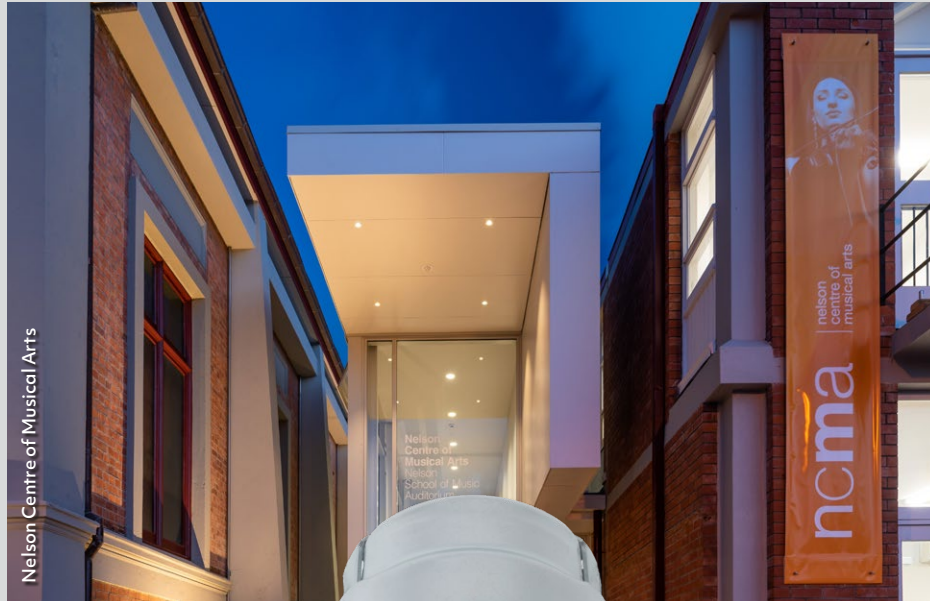

Nelson Centre of Musical Arts



**SLDF244F**  
Lens  
Beam 9° 15° 20°  
Spot lighting

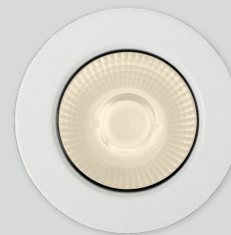

**SLDF247F**  
Asymmetric  
20°x55°  
Wall washing



**SLDF246F**  
Honeycomb  
Beam 30° 40°  
Anti-glare lighting



**SLDF242F**  
ULG clear  
Beam 40° 55°  
Task | General lighting

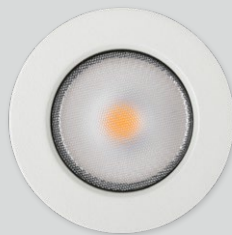

**SLDF241F**  
Prismatic diffuser  
Beam 40° 55°  
General | Task lighting

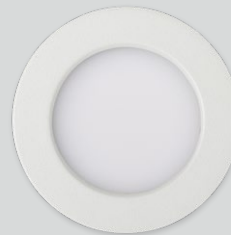

**SLDF243F**  
Opaque diffuser  
Beam 90°  
Wide angle lighting



# ZELA Fire Rated Fixed

- + maintain a stylish and modern appearance
- + BRANZ approved for GIB fire systems
- + compact size
- + IP65 front
- + constant current

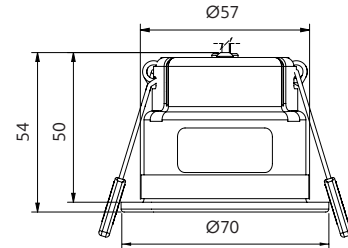

## Options

### Beam angle

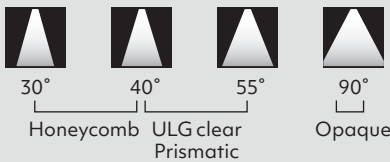

### Trim colour



### CCT



<sup>1</sup> Sunset Dimming is available in 30°, 40° and 55° in Professional series.  
<sup>2</sup> Tunable White is available in Asymmetric and 20°, 30°, 40°, 55° in Art series.

### CRI

Professional series (P) CRI 90-94 Art series (A) CRI 95-98

### Driver included – to be specified

- Phase cut Dimming
- DALI 2 Tunable White
- DALI 2 Dimming
- SLiC Casambi Tunable White
- SLiC Casambi Dimming



9-36VDC input options available  
 Scan the QR code for low voltage driver options

## Product information

**Table is based on:** White, prismatic, 40°, 3000K, CRI 90, phase cut driver  
 Contact Switch Lighting for data of other variants

Driver (mA)	Power (W)	Delivered lumens (lm)	Insulation coverable		
			NZ	AU	UK/EU
100	4.3	420	IC-F	IC-4	✓
150	6.4	590	IC-F	IC-4	✓
180	7.7	690	IC-F	IC-4	✓
220	9.4	810	CA135	CA90	✓
260	11.1	920	Do not cover		

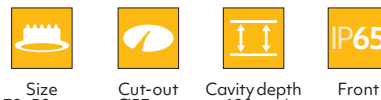

\*Fire Rated downlights must not be installed into a cavity of less than 190mm as tested to AS 1530.4:2014  
 Refer to our website for Technical Opinion Summary on approved systems.

## How to specify ZELA Fire Rated Fixed

Please confirm model option availability from our website. **Not every combination is compatible.**

e.g. code = **SLDF241F-4030P-TWD15**

Model	Beam	CCT	CRI	Trim Colour	Driver	Market
SLDF244F = Lens	09 = 9° 15 = 15° 20 = 20°	24 = 2400K 27 = 2700K 30 = 3000K 40 = 4000K	P = 90-94 A = 95-98	TW = Textured White TB = Textured Black	<b>Phase cut Dimming</b> D08 = 100mA (4.3W) D09 = 150mA (6.4W) D15 = 180mA (7.7W) D10 = 220mA (9.4W) D11 = 260mA (11.1W) <b>DALI 2 Tunable White</b> D42 = 180mA (8.3W) D43 = 230mA (10.1W) D44 = 260mA (11.9W)	1 = NZ 1 = Aust 2 = UK 3 = EU
SLDF246F = Honeycomb	30 = 30° 40 = 40°	SD = Sunset Dimming S2 = Tunable White			<b>DALI 2 Dimming</b> D02 = 150mA (8.3W) D03 = 200mA (10.1W) D04 = 250mA (11.9W) <b>SLiC Casambi Tunable White</b> D52 = 180mA (8.2W) <b>SLiC Casambi Dimming</b> D57 = 180mA (7.7W) D58 = 220mA (9.4W)	
SLDF242F = ULG clear glass SLDF241F = Prismatic	40 = 40° 55 = 55°				<b>Check online for other driver options.</b>	
SLDF247F = Asymmetric	W3 = 20°x 55°					
SLDF243F = Opaque	90 = 90°					

Please see [www.switch-lighting.co.nz](http://www.switch-lighting.co.nz) for full specifications, lux levels, SDcCs, ies files and installation instructions.



**Warranty**  
 7yr Luminaire  
 5yr Driver

L70 (60,000 h)

