

# ZELA *Deep Tilt*



Nelson private residence  
Tasman Sparkies



**SLDL224T**  
Lens  
Beam 9° 15° 20°  
Spot lighting



**SLDL226T**  
Honeycomb  
30° 40°  
Anti-glare lighting



**SLDL220T**  
Clear glass  
Beam 40° 55°  
Task | General lighting



**SLDL221T**  
Prismatic diffuser  
Beam 40° 55°  
General | Task lighting



**SLDL223T**  
Opaque diffuser  
Beam 90°  
Wide angle lighting

# ZELA Deep Tilt

- + slim trim for minimalist & modern design, deep recessed for low glare
- + general all purpose luminaire
- + fully adjustable 360° gimbal
- + suitable for indoor use and exterior under soffits
- + IP65 front
- + constant current

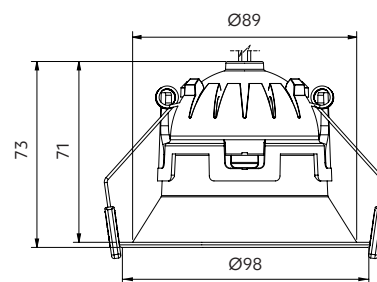

## Options

### Beam angle

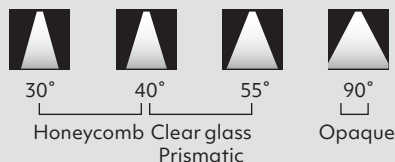
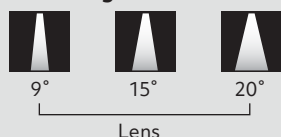

### Trim colour

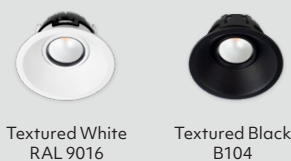

### CCT



<sup>1</sup> Sunset Dimming is available in 30°, 40° and 55° in Professional series.

<sup>2</sup> Tunable White is available in 20°, 30°, 40°, and 55° in Art series.

### CRI

Professional series (P) CRI 90-94 Art series (A) CRI 95-98

### Use with

ZELA adapter plates for retrofit installations

### Driver included – to be specified

Phase cut Dimming  
DALI 2 Tunable White  
DALI 2 Dimming  
SLiC Casambi Tunable White  
SLiC Casambi Dimming

## Product information

**Example:** White, prismatic, 40°, 3000K, CRI 90, phase cut driver

Contact Switch Lighting for data of other variants

Driver (mA)	Power (W)	Delivered lumens (lm)	Insulation coverable		
			NZ	AU	UK/EU
150	6.4	590	IC-F	IC-4	✓
180	7.7	690	IC-F	IC-4	✓
220	9.4	810	IC-F	IC-4	✓
260	11.1	920	IC-F	IC-4	✓
300	12.8	1020	CA135	CA90	✓



Tilt Angle  
28°



Size  
98x71mm



Cut-out  
Ø89mm



Hole depth  
>76mm<sup>\*</sup>



Front

<sup>\*</sup>Specification is for ceiling material ≤ 13mm with a phase cut driver.

## how to specify ZELA Deep Tilt

Please confirm model option availability from our website. **Not every combination is compatible.**

e.g. code = **SLDL221T-4030P-TWD11**

Model	Beam	CCT	CRI	Trim Colour	Driver	Market	
SLDL224T = Lens	09 = 9° 15 = 15° 20 = 20°	24 = 2400K 27 = 2700K 30 = 3000K 40 = 4000K	P = 90-94 A = 95-98	TW = Textured White TB = Textured Black	<b>Phase cut Dimming</b> D08 = 100mA (4.3W) D09 = 150mA (6.4W) D15 = 180mA (7.7W) D10 = 220mA (9.4W) D11 = 260mA (11.1W) D12 = 300mA (12.8W) <b>DALI 2 Tunable White</b> D42 = 180mA (8.3W) D43 = 230mA (10.1W) D44 = 260mA (11.9W)	<b>DALI 2 Dimming</b> D02 = 180mA (8.3W) D03 = 230mA (10.1W) D04 = 260mA (11.9W) <b>SLiC Casambi Tunable White</b> D54 = 260mA (11.8W) <b>SLiC Casambi Dimming</b> D57 = 180mA (11.8W) D59 = 260mA (11.8W) <b>Check online for other driver options.</b>	1 = NZ 1 = Aust 2 = UK 3 = EU
SLDL226T = Honeycomb	30 = 30° 40 = 40°	SD = Sunset Dimming S2 = Tunable White					
SLDL220T = Clear glass SLDL221T = Prismatic	40 = 40° 55 = 55°						
SLDL223T = Opaque	90 = 90°						

Please see [www.switch-lighting.co.nz](http://www.switch-lighting.co.nz) for full specifications, lux levels, SDoCs, ies files and installation instructions.



**Warranty**  
7yr Luminaire  
5yr Driver

L70 (60,000 h)

