

## SLiC-700E | CASAMBI enabled

### + Features

- Output current set from App
- 100% non-flicker DC dimming Current
- Current trim fine tuning
- Fading time adjustable
- Dimming curve adjustable
- Single colour and tunable white in one
- Very low standby power
- Premium low brightness performance

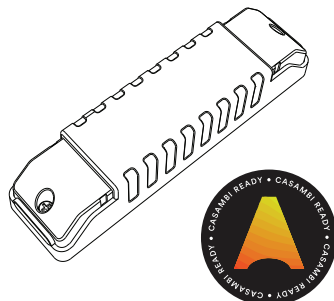

### + Introduction

The SLiC-700E is a 15W programmable constant current LED driver for tunable white and single colour. It is Casambi ready, and all features are programmable. The output channel, rated current, fade time and trim level features are all adjustable from the Casambi app. The advanced full DC dimming is 100% flicker free throughout the whole dimming range.

### + Setting output current and channel

The rated output current of SLiC-700E is from 200mA to 700mA and needs to be set from the Casambi app. To set the current and output mode, make sure the driver is unpaired and powered on. In the Casambi app, tap on the driver icon and select 'Change profile' option (Fig.1). The rated current and working mode can be selected in the list (Fig.2).

**CAUTION:** The SLiC-700E output current must not be set greater than the rating of the luminaire stated by manufacturer. Failure to do so may permanently damage luminaires, void warranty and/or present a fire risk.

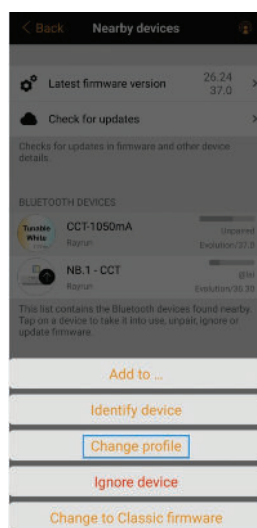

Fig.1

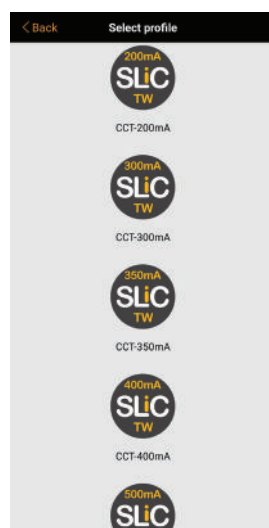

Fig.2

The SLiC-700E can be configured as tunable white or single colour. When configured as single colour, user can connect luminaire negative to either warm white (2-W) or cool white terminal (1-C).

The max output voltage varies with the rated output current. The following table lists the max output voltage and power with different current settings.

Rated current	200mA	250mA	300mA	350mA	400mA	500mA	600mA	700mA
Max output Volt.	50V	50V	50V	42.9V	37.5V	30V	25V	21.4V
Max power	10W	12.5W	15W					

### + Automatic LED calibration

The SLiC-700E verifies the load character at power on. It will run a load calibration process once the change of load is detected. During the calibration process, the luminaire will dim up and down for about 10 seconds. After this process, the driver will match the LED features and maintain a 0-100% full range non-flickering DC dimming.

### + Advanced feature - Current trimming

To fine tune the output current, pair the driver first and double click on the driver icon to open the setting page. On the setting page tap on the 'Current trim' in the PARAMETERS section (Fig.3). The output current can be trimmed from 100% to 50% of the rated current at 5% step (Fig.4). See current trim table.

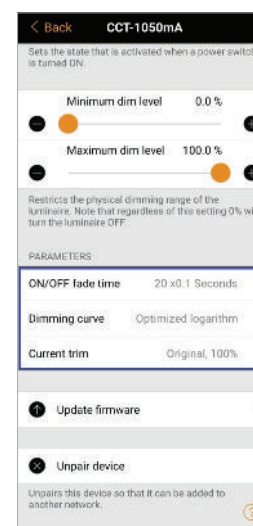

Fig.3



Fig.4

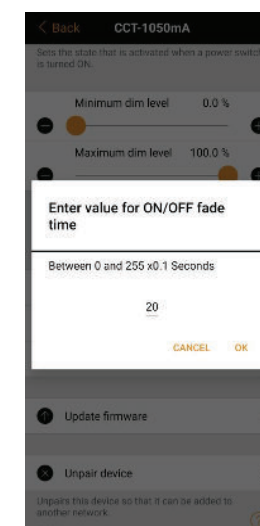

Fig.5

## SLiC-700E | CASAMBI enabled

### + Current Set Trim Table

The default profiles are in 50-100mA increments and can be set before or after pairing using the Casambi app. When first powered up the driver will be default set to 200mA.

Target Current mA	Set Current Profile mA	Set Trim Percentage	Comment
100	200	50%	
150	200	75%	
180	200	90%	
220	400	55%	
260	400	65%	
300	300	100%	No current trim necessary
350	500	75%	
400	400	100%	No current trim necessary

### + Advanced feature – On/OFF fade time adjustment

The on/off fade time can be adjusted on the settings page. Pair the driver first, open the settings page on the app and from the parameters section the on/off fade time can be adjusted from 0-25.5 seconds. Adjustment is made by entering a value between 0-225 with steps of 0.1 seconds [Fig.5].

### + Specification

Model	SLiC-700E	SLiC-700E
Function	2-in-1 (CCT/Single Color)	Single Color
Rated max power	15W	
Input power	AC 180-240V	
Power Factor	>0.9 at rated load	
Efficiency	>85% at full load	
Output voltage	0-50V DC	
Rated output current (mA)	200, 250, 300, 350, 400, 500, 600, 700	
Fade time	0-25.5 seconds adjustable	
Output current trim	100% to 50% with 5% step	
Dimming method	Full DC dimming	
Standby power consumption	<0.5W	
Working temperature	-20~50°C	
Case temperature	Max 90°C	
Dimension (WHL)	31.5 x 24 x 125.5mm	
Insulation Coverable	No	

### + Installation

1. Installation must be carried out by a registered electrician.
2. This device contains a bluetooth antenna – ensure the device is not installed adjacent metal objects and wiring.
3. Driver is NOT Insulation coverable in accordance with NZ standards.

### + Compatible devices

Suitable devices to run the Casambi App include iPhone & iPad iOS 10 and later, Android 4.4 and later. Most Apple and Android phones will be compatible.



For further information and detailed instructions on setting Scenes, Groups, Timers, Sensors, Circadian lighting profiles and much more please use the QR link

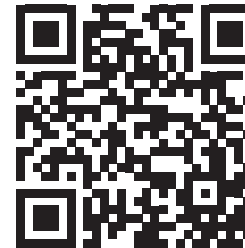

**Switch Lighting Head Office**  
 107 Bolt Road  
 Nelson  
 7011 New Zealand  
 +64 3 970 0755  
 sales@switch-lighting.co.nz  
 www.switch-lighting.co.nz

**Switch Lighting Technical Support**  
 +64 3 928 0039  
 support@switch-lighting.co.nz