



# sLED Lighting

## Lighting excellence for every space

Switch Lighting's sLED Lighting range is the economical choice for general illumination. Featuring energy-efficient LED technology, these products provide long-lasting, quality light with minimal power usage. The trim colours on the sLED DOME series are designed to perfectly complement the ZELA architectural range of lighting products, ensuring visual cohesion across all spaces within a property. Whether for residential or commercial applications, Switch Lighting's sLED range offers versatile, cost-effective solutions, seamlessly blending innovation with affordability.



The sLED Lighting range includes our new Up/Down Light! This versatile new product creates a soothing ambient, layered lighting effect. Accentuating architectural features and adding depth to a space by directing light both upwards and downwards.

The Switch Lighting Wall/Stair Light combines form and function to illuminate and accentuate hallways and stairs with sleek, efficient lighting.

Switch Lighting's commercial range boasts a selection of lighting solutions, from the high CRI or switchable CCT battens; the versatile Oyster Lights which are double insulated and dimmable; to the high-performance Commercial Downlights, which are designed to elevate any business environment with energy-efficient brilliance.

# SLED

by Switch Lighting



SSUD510F  
Single  
Up or down lighting



SSUD520F  
Double  
Up and down lighting





# Wall Light

Lighting excellence for every space

- + add a touch of drama & sophistication with multi-directional lighting
- + innovative Triple Layer Coating engineered for extended durability in coastal environments
- + wall mounted
- + suitable for indoor and outdoor applications
- + 230VAC internal dimming driver
- + High CRI
- + IP65 / IK07
- + constant current (Single 300mA, Double 500mA)

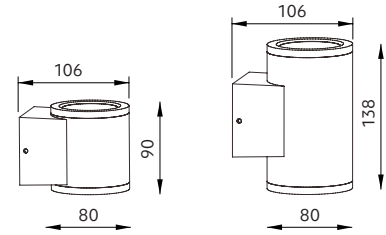

## Options

**Diffuser**  
Clear glass

### Beam angle

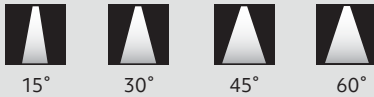

### CCT

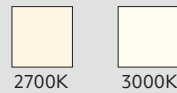

**CRI**  
CRI90

### Trim colour

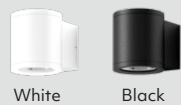

Driver included – built in

## Product information

Table is based on: 3000K  
Contact Switch Lighting for data of other variants

Model	System power (W)	Delivered lumens (lm)
SSUD510F	6.3	450
SSUD520F	11.1	740 (370x2)

### SSUD510F Single

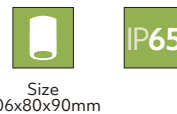

Size  
106x80x90mm

### SSUD520F Double



Size  
106x80x138mm

## How to specify sLED Wall Light

Please confirm model option availability from our website.

e.g. code = **SSUD510F-6030P-W**

Model	Beam	CCT	Pure Colour	Trim Colour
SSUD510F = Single	15 = 15°	27 = 2700K	P = CRI 90	W = White B = Black
	30 = 30°	30 = 3000K		
	45 = 45°			
	60 = 60°			

e.g. code = **SSUD520F-306030P-W**

Model	Beam 1	Beam 2	CCT	Pure Colour	Trim Colour
SSUD520F = Double	15 = 15°	15 = 15°	27 = 2700K	P = CRI 90	W = White B = Black
	30 = 30°	30 = 30°	30 = 3000K		
	45 = 45°	45 = 45°			
	60 = 60°	60 = 60°			

Please see [www.switch-lighting.co.nz](http://www.switch-lighting.co.nz) for specifications, lux levels, SDoCs, ies files and installation instructions.

Warranty  
5 Years

L70 (50,000h)

PURE COLOUR  
HIGH CRI DOWNLIGHTS

CONSTANT  
CC  
CURRENT



# SLED

by Switch Lighting



Nelson private residence  
The Custom Space Joinery



SSWS310  
Stair / wall lighting



SSWS320  
Stair / wall lighting



# Wall / stair light

## Lighting excellence for every space

- + stylish & safe stair lighting
- + compact size
- + flicker-free, non-dimming driver included
- + optional dimming driver
- + IP54 front
- + constant current (Max 350mA)

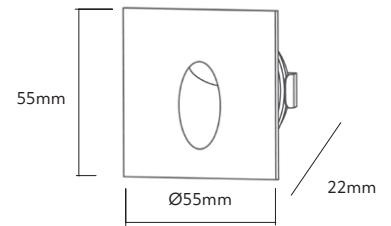
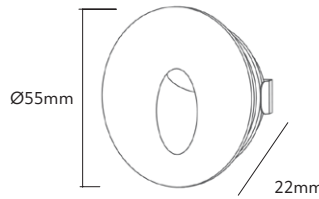

### Options

#### Beam angle



60°

#### CCT



2700K



3000K

#### Trim colour



Textured White  
RAL9003

#### CRI

CRI 80

#### Optional power supply – constant current

Ordered separately

##### 230VAC circuit (@350mA) only 2700K, 3000K, 4000K

1-4 lights	non-dimming Mini 350mA power supply
1-3 lights	TE dimmable SE-9-350-700
3-11 lights	TE dimmable SE-12-100-400
3-13 lights	TE dimmable SE-15-350-700
3-13 lights	dimmable SE-40-300-1050* (5-19 R, 3-12 G)

##### 12 or 24VDC circuit – all types:

1-3 lights	LDD-350LW @ 12VDC
1-7 lights	LDD-350LW @ 24VDC



Scan to view driver options

### Product information

**Table is based on: 3000K**

Contact Switch Lighting for data of other variants

CCT (K)	LED Power (W)	Delivered lumens (lm)	Insulation coverable		
			NZ	AU	UK/EU
3000	1	80	ICF	IC4	✓



Size 55x22mm



Cut-out Ø48-49mm



Hole depth >32mm



Front

### How to specify sLED Wall / Stair Light

Please confirm model option availability from our website.

e.g. code = **SSWS310-30-TW**

Model	CCT	Trim Colour	Market
<b>SSWS310</b> SSWS320	27 = 2700K <b>30</b> = 3000K	<b>TW</b> = Textured White (RAL9003)	<ul style="list-style-type: none"> <li>■ = NZ</li> <li>1 = Aust</li> <li>2 = UK</li> <li>3 = EU</li> </ul>

Please see [www.switch-lighting.co.nz](http://www.switch-lighting.co.nz) for specifications, lux levels, SDoCs, ies files and installation instructions.

**Warranty**  
5 Years



**SLED**  
by Switch Lighting

**DOME**



**SLED215F**  
Ø84mm  
Wide angle lighting

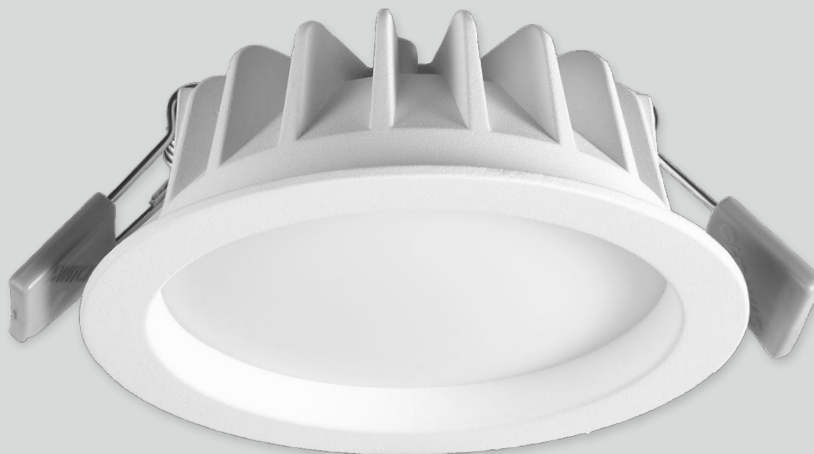

**SLED315F**  
Ø100mm  
Wide angle lighting



# sLED DOME Fixed

SLED 215F | SLED315F

- + general purpose flood lighting
- + switchable CCT
- + CRI 90
- + pure convex diffusion
- + trim matches ZELA range
- + IP65 front
- + constant current

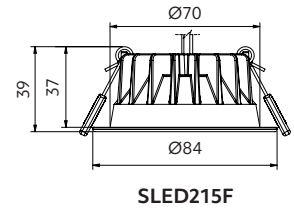
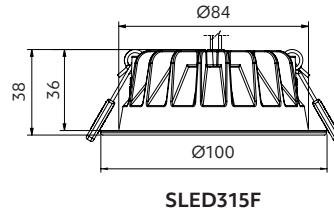

## Options

### Beam angle



110°

### Diffuser

Opaque

### Trim colour



Textured White  
RAL 9016



Textured Black  
B104

### Switchable CCT



2700K



3000K



4000K

### CRI

Professional series (P) CRI 90

### Driver

Phase cut dimming included



9-36VDC input options available  
Click the QR code for low voltage driver options

## Product information

Table is based on: 3000K, phase cut driver  
Contact Switch Lighting for data of other variants

Model	Power (W)	Delivered lumens (lm)*	Insulation coverable		
			NZ	AU	UK/EU
SLED215F	7	690	ICF	IC4	✓
SLED315F	10	800	ICF	IC4	✓

\*Please note: lumens are for the white version. Lumens for the black are reduced.

### SLED315F



Size 100x36mm



Cut-out Ø86-89mm



Hole depth >40mm



Front

### SLED215F



Size 84x37mm



Cut-out Ø70-73mm



Hole depth >40mm



Front

## How to specify SLED Fixed

e.g. code = **SLED315F-W1S1P-TW**

Model	Beam	Switchable CCT	CRI	Trim Colour
SLED215F SLED315F	W1 = 110° convex	S1 = 2700K   3000K   4000K	P = 90	TW = Textured White TB = Textured Black

Please see [www.switch-lighting.co.nz](http://www.switch-lighting.co.nz) for specifications, lux levels, SDoCs, ies files and installation instructions.



Warranty  
5 Years

L70 (60,000h)

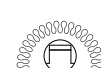

**SLED**  
by Switch Lighting

**DOME**



SLED415F  
Ø130mm  
Wide angle lighting

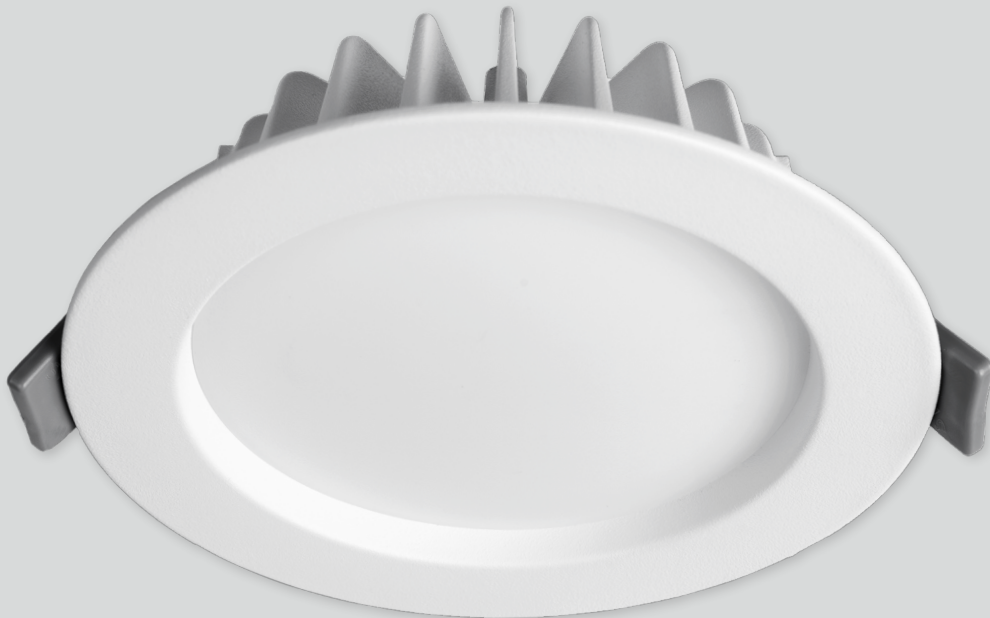

SLED515F  
Ø156mm  
Wide angle lighting



# sLED DOME Fixed

SLED415F | SLED515F

- + general purpose flood lighting
- + switchable CCT option
- + CRI 90
- + pure convex diffusion
- + trim matches ZELA range
- + sunset dimming option
- + IP65 front
- + constant current

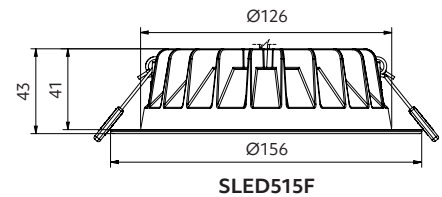
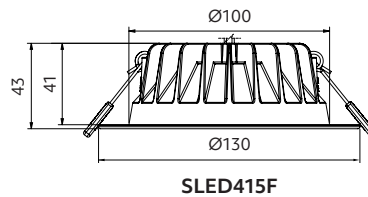

## Options

### Beam angle



110°

### Diffuser

Opaque

### Trim colour

Textured  
White  
RAL 9016Textured  
Black  
B104

### Switchable CCT



2700K



3000K



4000K

### Single CCT

3000K  
SLED415F  
12W4000K  
SLED515F  
20WSunset  
Dimming  
3000-2000K

### CRI

Professional series (P) CRI 90

### Driver

Phase cut dimming included

9-36VDC input options available  
Scan the QR code for low voltage driver options

## Product information

**Table is based on: 3000K, phase cut driver**

Contact Switch Lighting for data of other variants

Model	Power (W)	CCT (K)	Delivered lumens (lm)	Insulation coverable		
				NZ	AU	UK/EU
SLED415F	12.2	3000	1100	ICF	IC4	✓
SLED515F	12.2	3000	1100	ICF	IC4	✓

Please note: lumens are for the white version switchable CCT, 3000K single CCT and sunset dimming.

SLED515F	20.6	4000*	2000	ICF	IC4	✓
----------	------	-------	------	-----	-----	---

\*Please note: lumens are for the white version single CCT 4000K. Driver is Non IC.

### SLED415F

Size  
130x41 mmCut-out  
Ø100-120mmHole depth  
>45mm

Front

### SLED515F

Size  
156x41mmCut-out  
Ø127-140mmHole depth  
>45mm

Front

## How to specify SLED Fixed

e.g. code = **SLED415F-W1S1P-TW**

Model	Beam	CCT	CRI	Trim Colour	Market
SLED415F SLED515F	W1 = 110° convex	S1 = 2700K   3000K   4000K Switchable CCT SD = Sunset Dimming 30 = 3000K Single CCT (SLED415F, 12W only) 40 = 4000K Single CCT (SLED515F, 20W only)	P = 90	TW = Textured White TB = Textured Black	1 = NZ 2 = UK 3 = EU

Please see [www.switch-lighting.co.nz](http://www.switch-lighting.co.nz) for specifications, lux levels, SDCs, ies files and installation instructions.Warranty  
5 Years

L70 (60,000h)

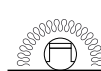

# SLED

by Switch Lighting

DOME



SLED315T  
Beam 110°  
Wide angle lighting



# sLED DOME Tilt

Lighting excellence for every space

- + switchable CCT
- + CRI 90
- + dimming driver
- + pure convex diffusion
- + trim matches ZELA range
- + IP44 front
- + constant current

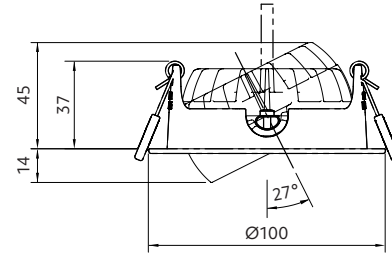

## Options

### Beam angle



110°

### Switchable CCT

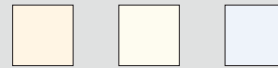

2700K 3000K 4000K

### Diffuser

Opaque

### CRI

Professional series (P) CRI 90

### Trim colour



Textured White  
RAL 9016

Textured Black  
B104

### Driver

Phase cut dimming included



9-36VDC input options available  
Scan the QR code for low voltage driver options

## Product information

CCT (K)	Power (W)	Delivered lumens (lm)	Insulation coverable		
			NZ	AU	UK/EU
2700	10	665	ICF	IC4	✓
3000	10	710	ICF	IC4	✓
4000	10	740	ICF	IC4	✓



Size  
100x45mm



Cut-out  
Ø86-89mm



Hole depth  
>45mm



IP44  
Front



Tilt Angle  
27°

\*Please note: lumens are for the white version. Lumens for the black are reduced.

## How to specify SLED315T

e.g. code = **SLED315T-W1S1P-TW**

Model	Beam	Switchable CCT	CRI	Trim Colour	Market
<b>SLED315T</b> = Tilt opaque	<b>W1</b> = 110° convex	<b>S1</b> = 2700K   3000K   4000K	<b>P</b> = 90	<b>TW</b> = Textured White <b>TB</b> = Textured Black	<ul style="list-style-type: none"> <li>■ = NZ</li> <li>1 = Aust</li> <li>2 = UK</li> <li>3 = EU</li> </ul>

Please see [www.switch-lighting.co.nz](http://www.switch-lighting.co.nz) for specifications, lux levels, SDoCs, ies files and installation instructions.



**Warranty**  
5 Years

L70 (60,000h)

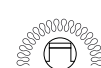

# *SLED*

by Switch Lighting



SLED314F-M1S5P-WW  
Medium angle lighting



SLED314F-M1S5P-BB  
Medium angle lighting



# SLED Low Glare Downlight

Lighting excellence for every space

- + CRI 90
- + dimming driver
- + low glare diffusion
- + IP54 front
- + quick connect flicker-free driver
- + switchable CCT
- + Halogen retrofit
- + up to 120 Lm/w efficacy
- + constant current

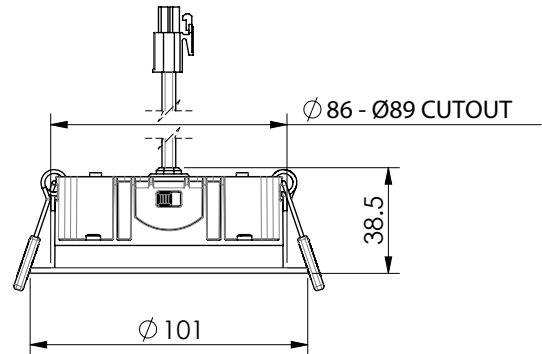

## Options

### Beam angle



90°

### Diffuser

Opaque

### Trim colour



Textured  
White  
RAL 9016



Textured  
Black  
B104

### Switchable CCT



2700K



3000K

### CRI

Professional series (P) CRI 90

### Driver

Phase cut dimming included

## Product information

CCT (K)	Power (W)	Delivered lumens (lm) White	Delivered lumens (lm) Black	Insulation coverable		
				NZ	AU	UK/EU
2700	8	>870	>600	ICF	IC4	✓
3000	8	>870	>600	ICF	IC4	✓



Size  
101x38.5mm



Cut-out  
Ø86-89mm



Hole depth  
>40mm



Front

## How to specify SLED314F

e.g. code = **SLED314F-M1S5P-BB**

Model	Beam	Switchable CCT	CRI	Trim Colour
<b>SLED314F</b> = Low glare	<b>M1</b> = 90°	<b>S5</b> = 2700K   3000K	<b>P</b> = 90	<b>BB</b> = Black WW = White

Please see [www.switch-lighting.co.nz](http://www.switch-lighting.co.nz) for specifications, lux levels, SDoCs, ies files and installation instructions.



Warranty  
5 Years

L70 (50,000h)

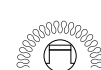

# sLED

by Switch Lighting



Wide angle lighting



SL50-30-W



SL55-30-W



SL56-30-W



# sLED Downlight

Lighting excellence for every space

- + wide angle flood lighting
- + 80% energy savings
- + dimming driver
- + IP44 front
- + constant current

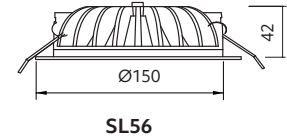
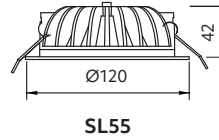
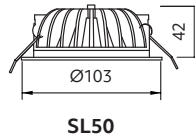

## Options

**Diffuser**  
Opaque

**CCT**



3000K



4000K  
SL50 only

**Beam angle**



90°

**CRI**

CRI 80

**Trim colour**



White



Black  
SL50 only

9-36VDC input options available  
Scan the QR code for low voltage driver options



## Product information

**Table is based on: 3000K**

Contact Switch Lighting for data of other variants

Model	Power (W)	Delivered lumens (lm)	Insulation coverable		
			NZ	AU	UK/EU
SL50	8.6	840	ICF	IC4	✓
SL55	12.8	1250	ICF	IC4	✓
SL56	12.8	1250	ICF	IC4	✓

SL50



Size  
103x42mm



Cut-out  
Ø89-92mm



Hole depth  
>45mm



Front

SL55



Size  
120x42mm



Cut-out  
Ø98-108mm



Hole depth  
>45mm



Front

SL56



Size  
150x42mm



Cut-out  
Ø122-135mm



Hole depth  
>45mm



Front

## How to specify sLED Downlight

e.g. code = **SL50-30-W**

Model	CCT	Trim Colour
SL50	30 = 3000K	W = White
SL55	40 = 4000K*	B = Black*
SL56		

\*Option only available in SL50.

Please see [www.switch-lighting.co.nz](http://www.switch-lighting.co.nz) for specifications, lux levels, SDoCs, ies files and installation instructions.



Warranty  
5 Years

L70 (54,000h)

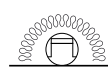

# **sLED**

by **Switch Lighting**



**SLCD121F**  
Ø170mm  
Commercial lighting



**SLCD131F**  
Ø190mm  
Commercial lighting



**SLCD151F**  
Ø235mm  
Commercial lighting



# Commercial Downlight

Lighting excellence for every space

- + low glare UGR<19
- + switchable CCT (3000/4000/5700K) or single CCT (4000K) options
- + flicker free dimmable driver included
- + L70 50,000 hours
- + IP54 front
- + constant current

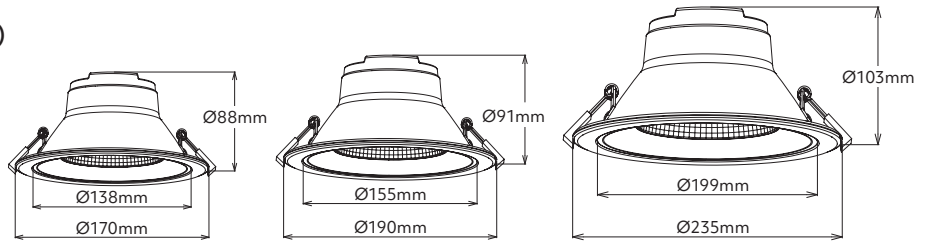

## Options

### Beam angle



60°

### Trim colour



White  
RAL 9016

### Switchable CCT



3000K



4000K



5700K

### Single CCT



4000K

### CRI

CRI 90

### Driver

DALI driver available.  
Please contact Switch Lighting.

## Product information

Table is based on: 60°, 4000K, CRI 90

Contact Switch Lighting for data of other variants

Model	Power (W)	Driver (mA)	Delivered lumens (lm)	Insulation Coverable		
				NZ	AU	UK/EU
SLCD121F	18	450	1600	ICF	IC4	✓
SLCD131F	18	450	1600	ICF	IC4	✓
SLCD151F	25	650	2300	ICF	IC4	✓

### SLCD121F



Size  
170x88mm



Cut-out  
Ø140-150mm



Hole depth  
>88mm



Front

### SLCD131F



Size  
190x90mm



Cut-out  
Ø160-170mm



Hole depth  
>91mm



Front

### SLCD151F



Size  
235x103mm



Cut-out  
Ø200-210mm



Hole depth  
>103mm



Front

## How to specify SLED Commercial

Please confirm model option availability from our website.

e.g. code = **SLCD121F-6040P-TWD62**

Model	Beam	CCT	Pure Colour	Trim Colour	Driver	Market
SLCD121F = Ø170mm SLCD131F = Ø190mm SLCD151F = Ø235mm	60 = 60°	S3 = 3000K   4000K   5700K (switchable) 40 = 4000K	P = CRI 90	TW = White	D62 = 450mA (18W) (SLCD121F   SLCD131F) D63 = 650mA (25W) (SLCD151F)	1 = NZ 1 = Aust 2 = UK 3 = EU

Please see [www.switch-lighting.co.nz](http://www.switch-lighting.co.nz) for specifications, lux levels, SDoCs, ies files and installation instructions.

Warranty  
5 Years

L70 (50,000h)

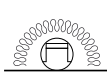

# **SLED**

by **Switch Lighting**



General lighting



SLOY100R-SC-W-W12



SLOY102R-SC-W-W18



SLOY106R-SC-W-W25



# Oyster light

Lighting excellence for every space

- + switchable CCT
- + 230VDC in-built driver
- + dimming
- + double insulated
- + IP54
- + IK-10
- + constant current

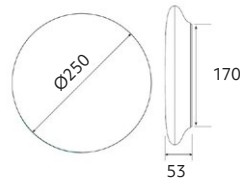

SLOY100R

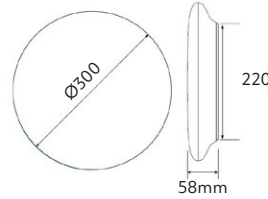

SLOY102R

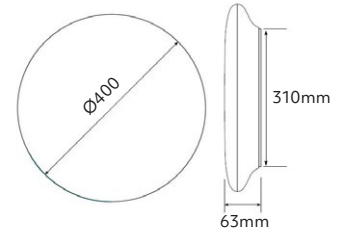

SLOY106R

## Options

### Beam angle



120°

### Switchable CCT



3000K



4000K



5700K

### CRI

CRI 80

### Trim colour



White

SLOY100R



Size  
Ø250x53mm

SLOY102R



Size  
Ø300x58mm

SLOY106R



Size  
Ø400x66mm

## Product specification information

Model	Diameter (inches)	Power (W)	Delivered lumens (lm)
SLOY100R-SC-W-W12	10"	12	1100
SLOY102R-SC-W-W18	12"	18	1900
SLOY106R-SC-W-W25	16"	25	2500

Please see [www.switch-lighting.co.nz](http://www.switch-lighting.co.nz) for specifications, lux levels, SDoCs, ies files and installation instructions.

Warranty  
3 Years

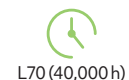

# sLED

by Switch Lighting

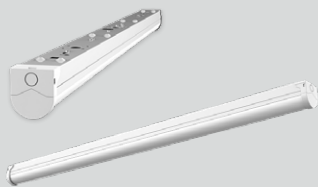
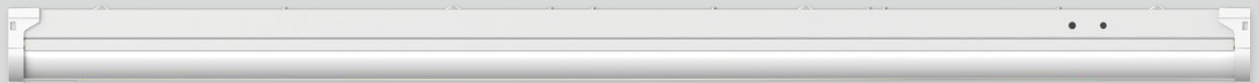

SLBN312  
1200mm  
General lighting

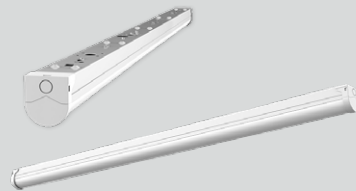

SLBN315  
1500mm  
General lighting



# Batten light

Lighting excellence for every space

- + up to 140Lm/W
- + fast installation
- + multiple cable entry points
- + flicker free non-dimming driver included
- + selectable power output
- + IP20
- + constant current

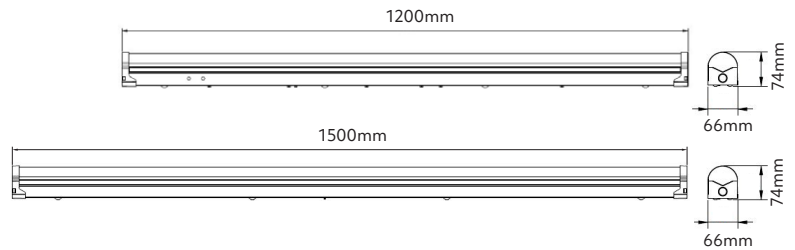

## Options

### Beam angle



120°

### Trim colour



White

### CCT



4000K



5000K



6500K

### CRI

CRI 90, CRI 95

### SLBN112



Size  
1.2mx66mm



### SLBN315



Size  
1.5mx66mm



## Product specification information

Model	Length (mm)	Emergency back-up	CCT (K)	Selectable power	Power (W)	Delivered lumens (lm)	CRI
SLBN312-40-P-W	1200	-	4000	Yes	38	4900	90
					35	4600	
					32	4200	
					29	3850	
SLBN315-40-P-W	1500	-	4000	Yes	60	8400	90
					56	7800	
					52	7200	
					45	6300	
SLBN315-65-P-W	1500	-	6500	Yes	60	8400	90
					56	7800	
					52	7200	
					45	6300	
SLBN335-40-P-W	1500	Yes	4000	No	60	8100	90
SLBN115-50-P-W	1500	-	5000	Yes	60	5940	95
					56	5540	
					52	5150	
					45	4460	

Please see [www.switch-lighting.co.nz](http://www.switch-lighting.co.nz) for specifications, lux levels, SDoCs, ies files and installation instructions.

Warranty  
5 Years

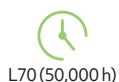

# *SLED*

by Switch Lighting



SLBN212  
1220mm



SLBN215 / SLBN235  
1520mm



# Under-veranda batten

Lighting excellence for every space

- + quick to install
- + strong rigid construction
- + multi CCT - 3000K, 4000K, 5700K
- + flicker-free
- + SS clips
- + hanging options included
- + sensor option
- + IP66, IK08
- + constant current

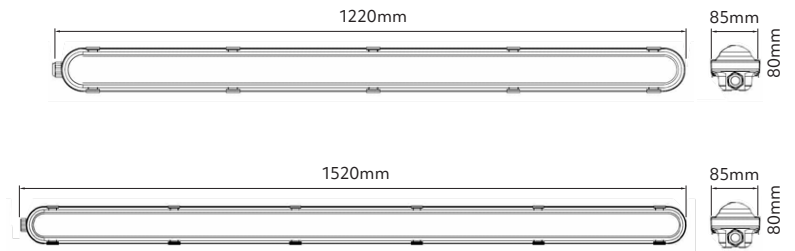

## Options

### Beam angle



120°

### Trim colour



White

### Switchable CCT



3000K



4000K



5700K

### CRI

CRI 80

## Accessory – Batten Sensor

- ultra-slim sensor for SLBN215 IP66 batten
- patented antenna design ensures reliable detection
- adjustable detection sensitivity via DIP switches makes it suitable for a variety of installation sites
- supports up to 6m max. mounting height
- easy installation (by registered electrician) complete kit to retro fit to battens
- 5 years warranty
- ordered separately

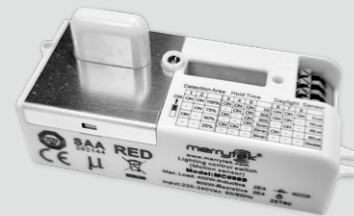

### SLBN212



Size  
1220x85x80mm



### SLBN215 / SLBN235



Size  
1520x85x80mm



## Product specification information

Model	Length (mm)	Emergency back-up	Sensor	Switchable CCT (K)	Power (W)	Delivered lumens (lm@4000K)	CRI
SLBN212-S3-W	1200	-	-	3000, 4000, 5700	34	4950	80
SLBN215-S3-W	1500	-	-	3000, 4000, 5700	52	7340	80
					45	6350	
					38	5360	
					32	4520	
SLBN235-S3-W	1500	Yes	-	3000, 4000, 5700	56	7280	80

Please see [www.switch-lighting.co.nz](http://www.switch-lighting.co.nz) for specifications, lux levels, SDoCs, ies files and installation instructions.

**Warranty**  
5 Years

