



Landscape Lighting

Elevate Your Outdoor Ambiance

Outdoor lighting improves visibility, enhances security, and creates a welcoming atmosphere, making it easier to navigate after dark and enjoy outdoor spaces throughout the year. Highlighting architectural features and creating an inviting ambiance for people to gather and socialise. Use outdoor lighting responsibly to minimise light pollution, energy consumption, and unnecessary costs. Create a safe and sustainable environment while preserving the natural beauty of the night sky.

Our popular Landscape Lighting products paired with smart controls, enable homeowners to create a multitude of lighting scenes for the purpose of beautification of the property, or entertaining guests alfresco, and enhancing security after dark. Switch Lighting Intelligent Controls seamlessly integrates into smart home controls, providing a simple and user-friendly solution for elevating outdoor spaces while ensuring energy efficiency in today's technologically advanced living spaces.

Our Switch Lighting range of products includes garden lights, bollards, deck lighting, feature lighting and more – to beautifully illuminate your outdoor spaces.

Switch Lighting has poured passion and expertise into crafting this new landscape lighting range. Meticulously designed and developed, with energy-efficient LED technology for weather-resistant durability, resulting in an enchanting illumination that transforms any outdoor space into a captivating paradise.

Choose from gorgeous hardwood Bollards with pure copper caps, elegant Path Lights with optional Extenders, Spot-Lightz to accent both indoor & outdoors spaces, and the tried, tested and loved Mini-LIGHTZ in three CCT & four colour variants. Switch Lighting is sure to bring your landscape to life!



PILLAR Light 1



Corner cut
SLBL100F



Bracket
SLMA-510

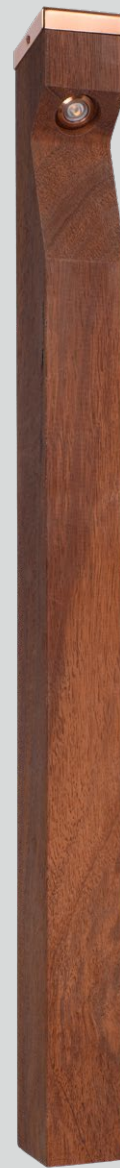

Straight cut
SLBL101F

Scan to view website



PILLAR Light 1

- + a pleasing addition to contemporary landscape design
- + use for gardens, paths, driveways
- + solid untreated hardwood
- + easy installation
- + low maintenance
- + IP67
- + constant current (Max 350mA)

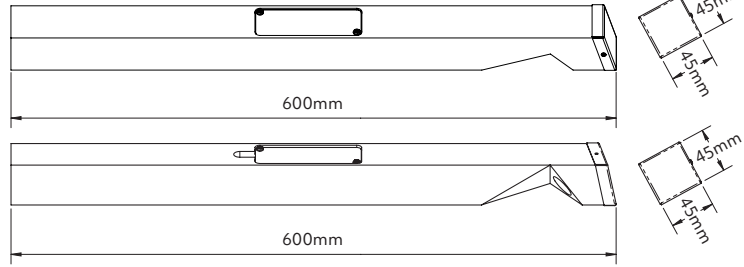

Options

Beam angle



wide

CCT

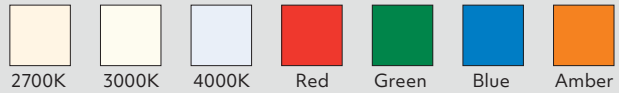

CRI

CRI 80 (2700K/3000K/4000K)

Trim colour



Copper

Power supply – constant current

Ordered separately

230VAC circuit Max 350mA only 2700K, 3000K, 4000K

1-4 lights	non-dimming Mini 350mA power supply
1-3 lights	TE dimmable SE-9-350-700
3-11 lights	TE dimmable SE-12-100-400
3-13 lights	TE dimmable SE-15-350-700
3-13 lights	dimmable SE-40-300-1050* (5-19 R, 3-12 G)

Use with

LED protector to protect from power and wiring hazards
Waterproof cable connectors

12 or 24VDC circuit – all types:

1-3 lights	LDD-350LW @ 12VDC
1-7 lights	LDD-350LW @ 24VDC

See driver options for coloured versions in Tips & Tricks on our website.

*1-10V, 0-10V, PWM, RX (variable resistor or rheostat)

Scan to view driver options



Product information

Table is based on: 3000K

Contact Switch Lighting for data of other variants

Luminaire power (W)	Delivered lumens (lm)	Forward voltage (V _f)	Max current
1	115	3	350mA



Size
600x45x45mm

How to specify PILLAR Light 1

Please confirm model option availability from our website. **Note: driver is ordered separately.**

e.g. code = **SLBL100F-W127-C**

Model	Beam	CCT	Trim Colour	Market
SLBL100F = corner cut SLBL101F = straight cut	W1 = wide angle	27 = 2700K 30 = 3000K 40 = 4000K R = Red G = Green B = Blue A = Amber	C = Copper	■ = NZ 1 = Aust 2 = UK 3 = EU

This product is made from natural timber. As such it may have tight knots, check marks or other slight imperfections.

Our copper variant is true copper and may contain small natural flaws. Over time, it will develop a patina, darkening in colour to a variety of rich tones. This process will be slower in areas where the fitting is not exposed to moisture.

Please see www.switch-lighting.co.nz for specifications, lux levels, SDoCs, ies files and installation instructions.



Warranty
5 Years

L70 (60,000 h)

PURE COLOUR
HIGH CRI DOWNLIGHTS

CONSTANT CURRENT
CC



PILLAR Light 2



Corner cut
SLBL120F Constant Voltage
SLBL122F Constant Current



Straight cut
SLBL121F Constant Voltage
SLBL123F Constant Current





PILLAR Light 2

- + enhance the aesthetic appeal of outdoor spaces
- + use for gardens / paths / driveways
- + solid untreated hardwood
- + easy installation
- + low maintenance
- + IP67
- + constant current (Max 500mA) /constant voltage (12 or 24VDC)

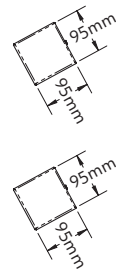

Options

Beam angle



wide

CCT

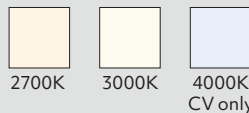

CRI

CRI 90 (2700K/3000K/4000K)

Trim colour



Copper

Use with

LED protector to protect from power and wiring hazards
Waterproof cable connectors

230VAC power supply – constant current

Ordered separately
Max 500mA
See Tips & Tricks on our website for driver options.

12 or 24VDC power supply – constant voltage

Ordered separately
Q4-12V-20W (IP20) 1-3 lights in parallel
SLDV-12V-40W (IP67) 1-6 lights in parallel
Please refer online for cable size requirements (voltage drop)



Scan to view driver options

Product information

Table is based on: 3000K
Contact Switch Lighting for data of other variants

Model	Luminaire power (W)	Forward voltage (V _f)	Delivered lumens (lm)
SLBL122F SLBL123F constant current (CC)	3	6	310
SLBL120F SLBL121F constant voltage (CV)	4.2	11-30	320



Size
1100x95x95mm

How to specify PILLAR Light 2

Please confirm model option availability from our website. **Note: driver is ordered separately.**

e.g. code = **SLBL120F-W127-C**

Model	Beam	CCT	Trim Colour	Market
SLBL120F = corner cut constant voltage SLBL121F = straight cut constant voltage SLBL122F = corner cut constant current SLBL123F = straight cut constant current	W1 = wide angle	27 = 2700K 30 = 3000K 40 = 4000K (CV only)	C = Copper	■ = NZ 1 = Aust 2 = UK 3 = EU

This product is made from natural timber. As such it may have tight knots or other slight imperfections. Our copper variant is true copper and may contain small natural flaws. Over time, it will develop a patina, darkening in colour to a variety of rich tones. This process will be slower in areas where the fitting is not exposed to moisture.

Please see www.switch-lighting.co.nz for specifications, lux levels, SDoCs, ies files and installation instructions.



Warranty
5 Years

L70 (60,000 h)

PURE COLOUR
HIGH CRI DOWNLIGHTS

CONSTANT CURRENT

CONSTANT VOLTAGE



Path Light 1

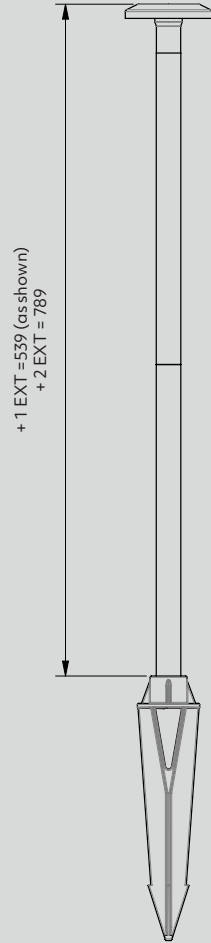

SLSPK-2-EXT
Extender accessory
1 is included
an additional 1-2
can be used

SLGL310



Natural Anodised
Aluminium



Black Anodised
Aluminium



Copper



316 Stainless Steel



Path Light 1

- + infuse outdoor spaces with a touch of elegance
- + stainless steel and anodised options for coastal high wear & corrosion resistance
- + extensions available
- + use outdoors for garden / path lighting
- + IP65
- + constant current (Max 700mA)

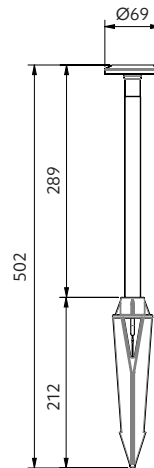

Scan to view website

Options

Beam angle



wide

Trim colour



Natural Anodised Aluminium



Black Anodised Aluminium



Copper



316 Stainless Steel

CCT



2700K



3000K



4000K



Red



Green



Blue



Amber

Extender

250mm

SLSPK-2-EXT-B Black Anodised Aluminium

SLSPK-2-EXT-N Natural Anodised Aluminium

SLSPK-2-EXT-C Copper

SLSPK-2-EXT-SS 316 Stainless Steel

Use with

LED protector to protect from power and wiring hazards

Waterproof cable connectors

1-3 lights LDD-350LW @ 12VDC

1-7 lights LDD-350LW @ 24VDC

230VAC power supply – constant current

Ordered separately

Max 350mA

1-3 lights non-dimming Mini350mA power supply

1-3 lights TE dimmable SE-9-350-700

3-11 lights TE dimmable SE-12-100-400 (4-14 R, 3-10 G)

3-13 lights TE dimmable SE-15-350-700 (4-17 R, 3-12 G)

3-13 lights dimmable SE-40-300-1050* (5-19 R, 3-12 G)*

12 or 24VDC circuit

See driver options for coloured versions in Tips & Tricks on our website.

*1-10V, 0-10V, PWM, RX (variable resistor or rheostat)



Scan to view driver options

Product information

Table is based on: 3000K

Contact Switch Lighting for data of other variants

Driver (mA)	Luminaire power (W)	Delivered lumens (lm)	Forward voltage (V _f)
350	1	68	3
700	2.2	125	3



Size
Ø69x502mm



Spike size
Ø50x212mm



How to specify Path Light 1

Please confirm model option availability from our website. **Note: driver is ordered separately.**

e.g. code = **SLGL310-W230N-SPK** (2700K, 3000K, 4000K); **SLGL310-W2RN-SPK** (Red, Green, Blue, Amber)

Model	Beam	CCT	Trim Colour
SLGL310	W2 = 115°	27 = 2700K 30 = 3000K 40 = 4000K	N = Natural Anodised Aluminium B = Black Anodised Aluminium C = Copper SS = 316 Stainless Steel
SLGL310	W2 = 115°	R = Red G = Green B = Blue A = Amber	N = Natural Anodised Aluminium B = Black Anodised Aluminium C = Copper SS = 316 Stainless Steel

Please see www.switch-lighting.co.nz for specifications, lux levels, SDoCs, ies files and installation instructions.



Warranty
5 Years

L70 (60,000 h)

PURE COLOUR
HIGH CRI DOWNLIGHTS

CONSTANT CURRENT
CC



Marker-LIGHTZ



SLSPK
Spike accessory

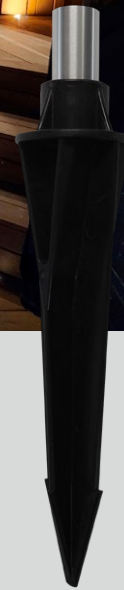

SLSPK-2
Spike 2 accessory



SLSPK-2-EXT
Extender accessory
1-3 can be used
with Spike 2

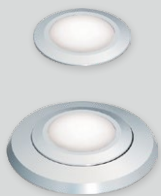

Natural Anodised
Aluminium



Black Anodised
Aluminium

Friction Fit
SL231

Spring Mount
SL241



Copper

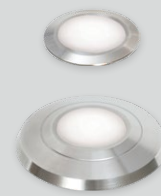

316 Stainless Steel





Marker-LIGHTZ

- + subtle illumination creating understated ambiance
- + tiny form factor
- + use outdoors on decks / driveways / retaining walls
- + improves safety while navigating after dark
- + constant voltage (12VDC)
- + IP67

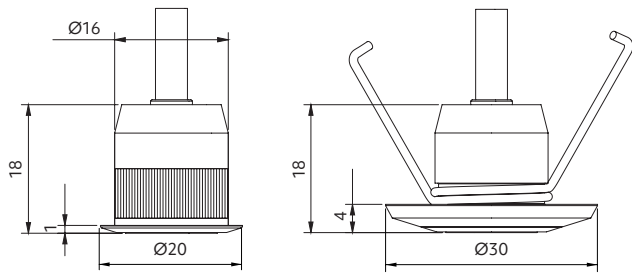

Options

Beam angle



Wide

Colour



Red



Green



Blue



White

Trim colour



Natural Anodised Aluminium



Black Anodised Aluminium



Copper



316 Stainless Steel

Power supply – constant voltage

Ordered separately

Q4-12V-20W (IP20) 1-680 lights in parallel (IP20)

SLDV-12V-40W (IP67) 1-1200 lights in parallel (IP67)

Please refer online for cable size requirements (voltage drop)

Use with

Waterproof cable connectors

Spike



200mm for SL201

SLSPK-B Black Anodised Aluminium

SLSPK-N Natural Anodised Aluminium

SLSPK-C Copper

SLSPK-SS 316 Stainless Steel

Spike 2

212mm for SL201

SLSPK-2-B Black Anodised Aluminium

SLSPK-2-N Natural Anodised Aluminium

SLSPK-2-C Copper

SLSPK-2-SS 316 Stainless Steel



Extender for use with Spike 2

250mm

SLSPK-2-Ext-B Black Anodised Aluminium

SLSPK-2-Ext-N Natural Anodised Aluminium

SLSPK-2-Ext-C Copper

SLSPK-2-Ext-SS 316 Stainless Steel



Scan to view driver options

Product information

Power supply (VDC)	Luminaire power (mW)	Delivered lumens (lm)	Insulation coverable		
			NZ	AU	UK/EU
12	<30 (2.5mA)	<1	IC-F	IC-4	✓

SL231 Friction fit



Size 20x18mm



Cut-out Ø16mm



Hole depth >26mm



SL241 Spring mount



Size 30x18mm



Cut-out Ø20mm



Hole depth >26mm



How to specify Marker-LIGHTZ

Please confirm model option availability from our website. **Note: power supply is ordered separately.**

e.g. code = **SL231-G-N**

Model	Colour	Trim Colour	Market
SL231	R = Red	N = Natural Anodised Aluminium	1 = NZ
SL241	G = Green	B = Black Anodised Aluminium	1 = Aust
	B = Blue	C = Copper	2 = UK
	W = White	SS = 316 Stainless Steel	3 = EU

Please see www.switch-lighting.co.nz for specifications, lux levels, SDoCs, ies files and installation instructions.



Warranty
5 Years

L70 (50,000 h)



Spot-LIGHTZ Mini

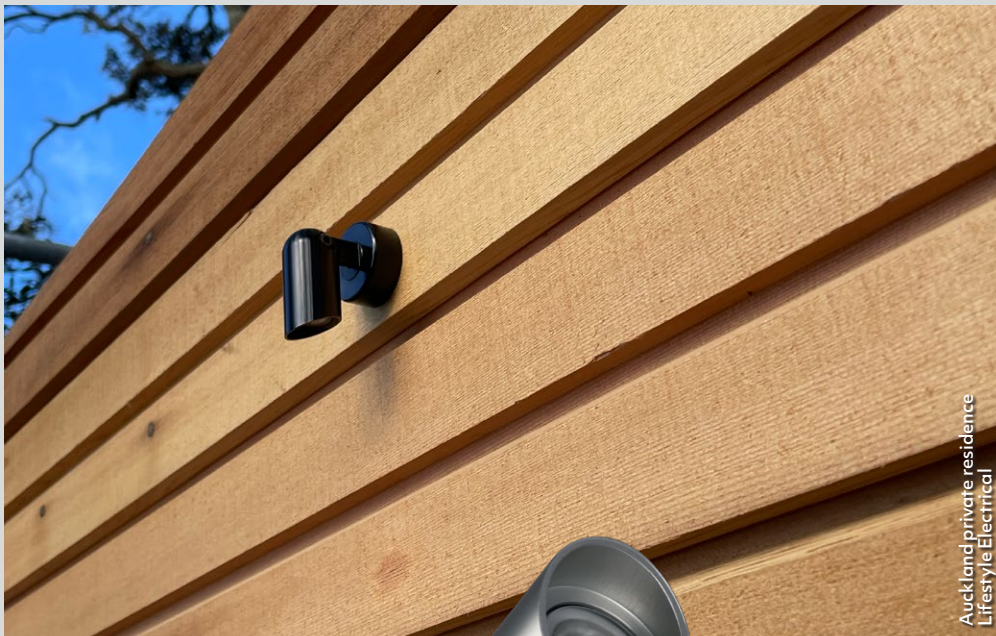

Auckland private residence
Lifestyle Electrical



SLGL242



Natural Anodised
Aluminium



Black Anodised
Aluminium



316 Stainless Steel

Scan to view website



Spot-LIGHTZ Mini

- + precision beam control to accentuate architectural features
- + stainless steel & anodised options for coastal high wear & corrosion resistance
- + use outdoors for landscape lighting / illuminate features / under soffits
- + use indoors to illuminate features / accentuate art
- + constant current (Max 700mA)

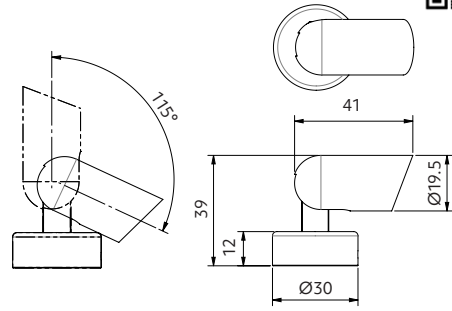

Options

Beam angle



CCT

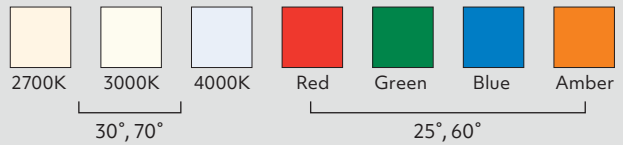

Trim colour

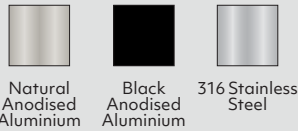

Use with

LED protector to protect from power and wiring hazards
Waterproof cable connectors

Power supply – constant current

Ordered separately

230VAC circuit (@350mA 1W)

- 1-3 lights non-dimming Mini350mA power supply
- 1-3 lights TE dimmable SE-9-350-700
- 3-11 lights TE dimmable SE-12-100-400 (4-14 R, 3-10 G)
- 3-13 lights TE dimmable SE-15-350-700 (4-17 R, 3-12 G)
- 3-13 lights dimmable SE-40-300-1050* (5-19 R, 3-12 G)

230VAC circuit (@700mA Max 2.2W)

- 1 light non-dimming Mini700mA power supply
- 1-3 lights TE dimmable SE-9-350-700
- 3-6 lights TE dimmable SE-15-350-700 (4-8 R)
- 3-13 lights dimmable SE-40-300-1050* (5-19 R, 3-12 G)

12 or 24VDC circuit (@350mA 1W)

- 1-3 lights LDD-350LW @ 12VDC
- 1-7 lights LDD-350LW @ 24VDC

12 or 24VDC circuit (@700mA Max 2.2W)

- 1-3 lights LDD-700LW power supply @ 12VDC
- 1-6 lights LDD-700LW power supply @ 24VDC

*1-10V, 0-10V, PWM, RX
(variable resistor or rheostat)



Scan to view driver options

Product information

Table is based on: 3000K

Contact Switch Lighting for data of other variants

Driver (mA)	Luminaire power (W)	Delivered lumens (lm)	Forward voltage (V _f)
350	1	115	3
700	2.2	215	3



Size
Ø19.5x41mm

How to specify Spot-LIGHTZ Mini

Please confirm model option availability from our website. **Note: driver is ordered separately.**

e.g. code = [SLGL242-7030C-N](#) (2700K, 3000K, 4000K); [SLGL242-25-R-N](#) (Red, Green, Blue, Amber)

Model	Beam	CCT	Series	Trim Colour
SLGL242 - Surface mount	30 = 30° 70 = 70°	27 = 2700K 30 = 3000K 40 = 4000K	C = Classic	N = Natural Anodised Aluminium B = Black Anodised Aluminium SS = 316 Stainless Steel
SLGL242 - Surface mount	25 = 25° 60 = 60°	R = Red G = Green B = Blue A = Amber		N = Natural Anodised Aluminium B = Black Anodised Aluminium SS = 316 Stainless Steel

Please see www.switch-lighting.co.nz for specifications, lux levels, SDoCs, ies files and installation instructions.



Warranty
5 Years

L70 (60,000 h)



Spot-LIGHTZ Mini + Spike



SLSPK-2-EXT
Extender accessory
1-3 can be used



SLGL252

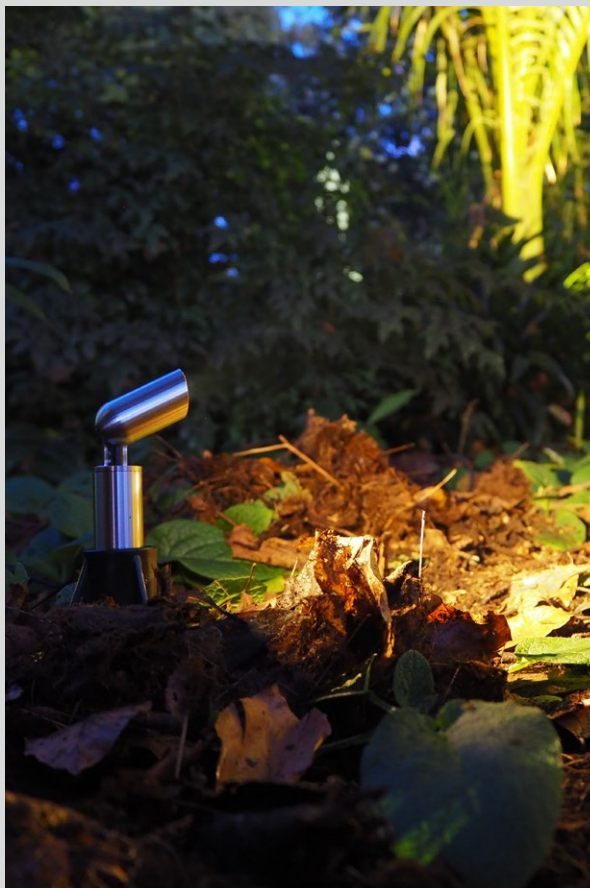

+ 1 EXT = 309
+ 2 EXT = 559 (as shown)
+ 3 EXT = 809

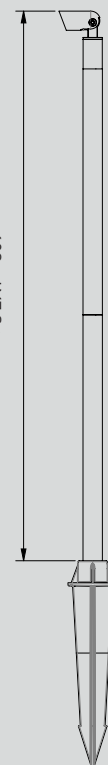

Natural Anodised
Aluminium



Black Anodised
Aluminium



316 Stainless Steel



Spot-LIGHTZ Mini + Spike

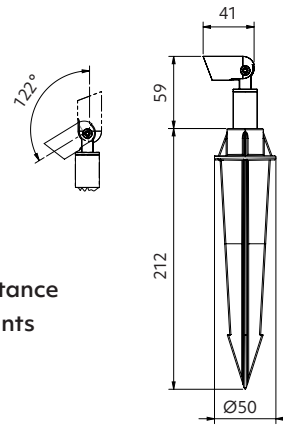

Scan to view website

- + practical & precision illumination to accentuate landscapes
- + stainless steel and anodised options for coastal high wear & corrosion resistance
- + use outdoors for gardens / path lighting / to highlight architectural elements
- + IP67
- + constant current (Max 700mA)

Options

Beam angle

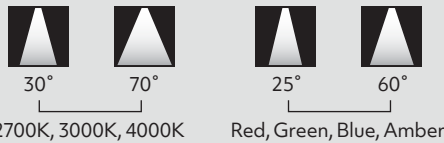

CCT

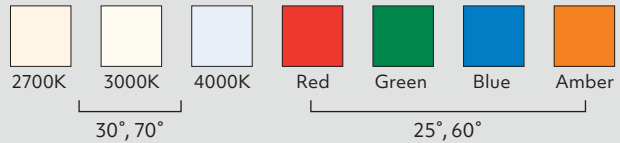

Trim colour

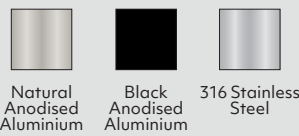

Extender

- 250mm
- SLSPK-2-Ext-B Black Anodised Aluminium
- SLSPK-2-Ext-N Natural Anodised Aluminium
- SLSPK-2-Ext-SS 316 Stainless Steel

Use with

- LED protector to protect from power and wiring hazards
- Waterproof cable connectors

Power supply – constant current

Ordered separately

230VAC circuit (@350mA 1W)

- 1-3 lights non-dimming Mini350mA power supply
- 1-3 lights TE dimmable SE-9-350-700
- 3-11 lights TE dimmable SE-12-100-400 (4-14 R, 3-10 G)
- 3-13 lights TE dimmable SE-15-350-700 (4-17 R, 3-12 G)
- 3-13 lights dimmable SE-40-300-1050* (5-19 R, 3-12 G)

230VAC circuit (@700mA Max 2.2W)

- 1 light non-dimming Mini700mA power supply
- 1-3 lights TE dimmable SE-9-350-700
- 3-6 lights TE dimmable SE-15-350-700 (4-8 R)
- 3-13 lights dimmable SE-40-300-1050* (5-19 R, 3-12 G)

12 or 24VDC circuit (@350mA 1W)

- 1-3 lights LDD-350LW @ 12VDC
- 1-7 lights LDD-350LW @ 24VDC

12 or 24VDC circuit (@700mA Max 2.2W)

- 1-3 lights LDD-700LW power supply @ 12VDC
- 1-6 lights LDD-700LW power supply @ 24VDC

*1-10V, 0-10V, PWM, RX (variable resistor or rheostat)



Scan to view driver options

Product information

Table is based on: 3000K

Contact Switch Lighting for data of other variants

Driver (mA)	Luminaire power (W)	Delivered lumens (lm)	Forward voltage (V _f)
350	1	115	3
700	2.2	215	3



Size
Ø19.5x41mm



Spike size
Ø50x212mm



How to specify Spot-LIGHTZ Mini + Spike

Please confirm model option availability from our website. **Note: driver is ordered separately.**

e.g. code = **SLGL252-7030C-N** (2700K, 3000K, 4000K); **SLGL252-25-R-N** (Red, Green, Blue, Amber)

Model	Beam	CCT	Series	Trim Colour
SLGL252	30 = 30° 70 = 70°	27 = 2700K 30 = 3000K 40 = 4000K	C = Classic	N = Natural Anodised Aluminium B = Black Anodised Aluminium SS = 316 Stainless Steel
SLGL252	25 = 25° 60 = 60°	R = Red G = Green B = Blue A = Amber		N = Natural Anodised Aluminium B = Black Anodised Aluminium SS = 316 Stainless Steel

Please see www.switch-lighting.co.nz for specifications, lux levels, SDoCs, ies files and installation instructions.



Warranty
5 Years

L70 (60,000h)



Spot-LIGHTZ

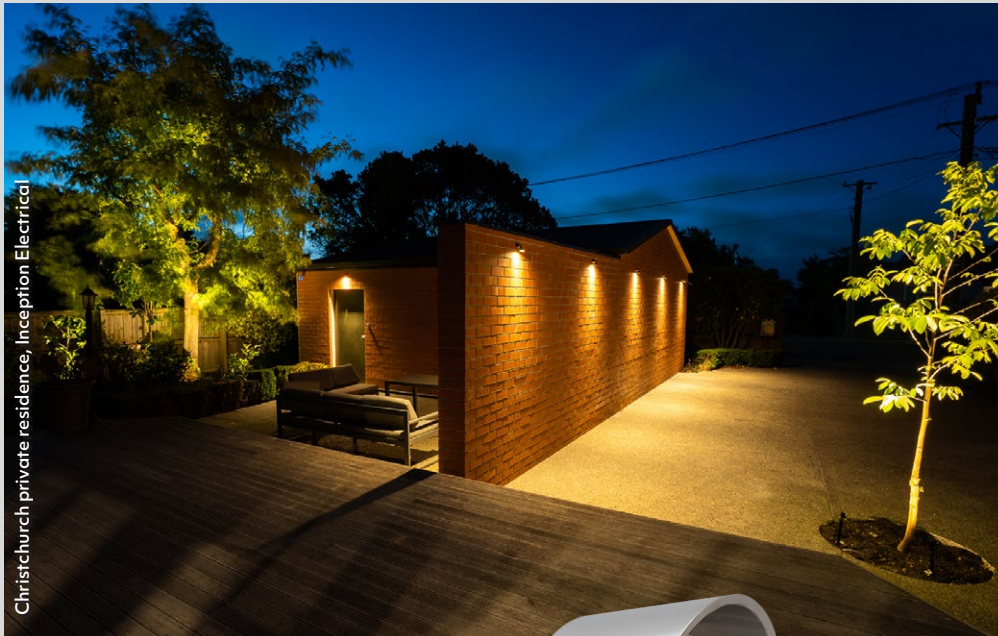

Christchurch private residence, Inception Electrical



SL224 Constant Voltage
SL244 Constant Current



Natural Anodised
Aluminium



Black Anodised
Aluminium



Copper



316 Stainless Steel



Scan to view website



Spot-LIGHTZ

- + combines durability & functionality for exceptional illumination
- + use for gardens / features / walkways / decks / indoors
- + adjustable head
- + surface mount
- + IP67
- + constant voltage (12 or 24VDC)
- + constant current (Max 500mA)

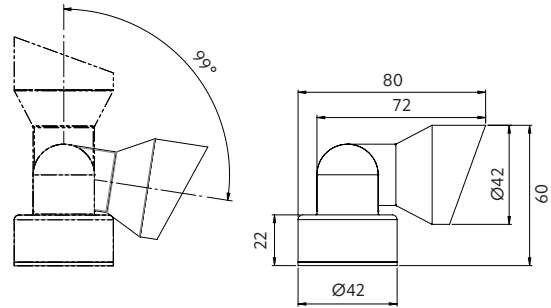

Options

Beam angle



Trim colour

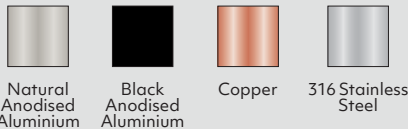

230VAC power supply – constant current

Ordered separately
Max 500mA
See Tips and Tricks on our website for driver options.

Use with

Waterproof cable connectors

CCT

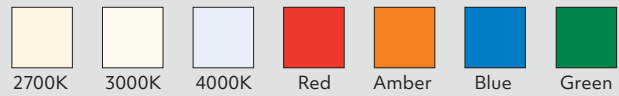

Constant current

All CCT available in constant voltage.

CRI

CRI 80 (2700K/3000K/4000K)

Power supply – constant voltage

Ordered separately.

Q4-12V-20W (IP20)	1-3 lights in parallel
SLDV-12V-40W (IP67)	1-7 lights in parallel
SLDV-12V-75W (IP67)	1-13 lights in parallel
SLDV-24V-75W (IP67)	1-10 lights in parallel
SLDV-24V-150W (IP67)	1-20 lights in parallel

Other drivers available.

Spot-LIGHTZ (2700K, 3000K, 4000K, red, amber) require a power supply with 12 or 24VDC output

Spot-LIGHTZ (green, blue) require a power supply with 24VDC output
Please refer online for cable size requirements (voltage drop)



Scan to view driver options

Product information

Table is based on: 3000K

Contact Switch Lighting for data of other variants

Model	Luminaire power (W)	Forward voltage (V _f)	Delivered lumens (lm)
SL224 - constant voltage	5.3	12	415
SL224 - constant voltage	5.3	24	415
SL244 - constant current	4.5	9	475



Size 42x72mm Head unit



Size 42mm Base



How to specify Spot-LIGHTZ

Please confirm model option availability from our website. **Note: power supply is ordered separately.**

e.g. code = **SL224-40-30-N**

Model	Beam	CCT	Trim Colour	Market
SL224 = constant voltage SL244 = constant current	15 = 15° 40 = 40°	27 = 2700K (constant voltage, constant current) 30 = 3000K (constant voltage, constant current) 40 = 4000K (constant voltage) R = Red (constant voltage) A = Amber (constant voltage) G = Green (constant voltage, 24VDC only) B = Blue (constant voltage, 24VDC only)	N = Natural Anodised Aluminium B = Black Anodised Aluminium C = Copper SS = 316 Stainless Steel	N = NZ 1 = Aust 2 = UK 3 = EU

Please see www.switch-lighting.co.nz for specifications, lux levels, SDoCs, ies files and installation instructions.



Warranty
5 Years

L70 (36,000h)



Spot-LIGHTZ Spike



SL234



SLGL234
SLGL254



SLSPK-2-EXT
Extender accessory
1-3 can be used with
SLGL234 and
SLGL254 only

+ 1 EXT = 331
+ 2 EXT = 581 (as shown)
+ 3 EXT = 831



Natural Anodised
Aluminium

Spike Mount
SL234
Spike 2 Mount
SLGL234
SLGL254



Black Anodised
Aluminium

Spike Mount
SL234
Spike 2 Mount
SLGL234
SLGL254



Copper

Spike Mount
SL234
Spike 2 Mount
SLGL234
SLGL254



316 Stainless Steel

Spike Mount
SL234
Spike 2 Mount
SLGL234
SLGL254



Spot-LIGHTZ Spike

- + robust enhancement for the outdoors
- + use for gardens / features / walkways / decks
- + adjustable head
- + optional extender for SLGL234 / SLGL254
- + IP67
- + constant voltage (12 or 24 VDC) / constant current (Max 500mA)

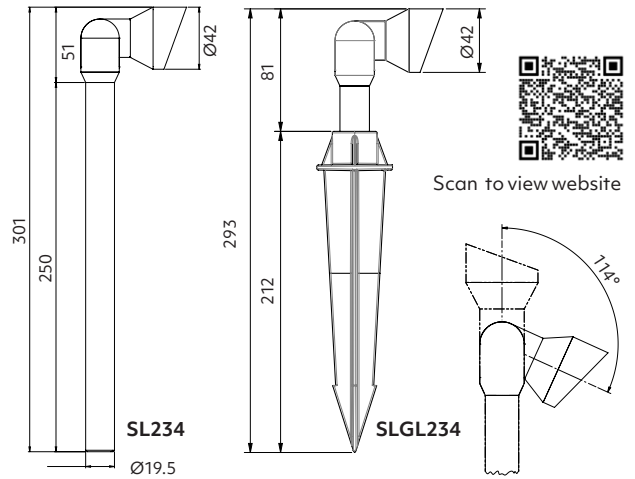

Options

Beam angle



Trim colour

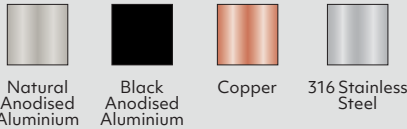

Power supply – constant voltage

Ordered separately.

Q4-12V-20W (IP20)	1-3 lights in parallel
SLDV-12V-40W (IP67)	1-7 lights in parallel
SLDV-12V-75W (IP67)	1-13 lights in parallel
SLDV-24V-75W (IP67)	1-10 lights in parallel
SLDV-24V-150W (IP67)	1-20 lights in parallel

Other drivers available.

Spot-LIGHTZ

require a power supply with 12 or 24VDC output (2700K, 3000K, 4000K, red, amber)

Spot-LIGHTZ

require a power supply with 24VDC output (green, blue)
Please refer online for cable size requirements (voltage drop)

CCT



Constant current

All CCT available in constant voltage.

CRI

CRI 80 (2700K/3000K/4000K)

Use with

Waterproof cable connectors

Extender for SLGL234/SLGL254

250mm

SLSPK-2-Ext-B	Black Anodised Aluminium
SLSPK-2-Ext-N	Natural Anodised Aluminium
SLSPK-2-Ext-C	Copper
SLSPK-2-Ext-SS	316 Stainless Steel

230VAC Power supply – constant current

Ordered separately

Max 500mA

See Tips and Tricks on our website for driver options.

Scan to view driver options

Product information

Table is based on: 3000K

Contact Switch Lighting for data of other variants

Model	Luminaire power (W)	Forward voltage (V _f)	Delivered lumens (lm)
SL234 - constant voltage	5.3	12	415
SLGL234 - constant voltage	5.3	24	415
SLGL254 - constant current	4.5	9	475

SL234 Spike mount



Size
42x72mm
Head unit



Size
19.5x250mm
Spike length



SLGL234/SLGL254

Spike mount 2



Size
42x72mm
Head unit



Spike size
Ø50x212mm



How to specify Spot-LIGHTZ Spike

Please confirm model option availability from our website. **Note: power supply is ordered separately.**

e.g. code = **SL234-40-27-N**

Model	Beam	CCT	Trim Colour	Market
SL234 = Spike mount constant voltage SLGL234 = Spike 2 mount constant voltage SLGL254 = Spike 2 mount constant current	15 = 15° 40 = 40°	27 = 2700K (constant voltage, constant current) 30 = 3000K (constant voltage, constant current) 40 = 4000K (constant voltage) R = Red (constant voltage) A = Amber (constant voltage) G = Green (constant voltage, 24VDC only) B = Blue (constant voltage, 24VDC only)	N = Natural Anodised Aluminium B = Black Anodised Aluminium C = Copper SS = 316 Stainless Steel	NZ = NZ 1 = Aust 2 = UK 3 = EU

Please see www.switch-lighting.co.nz for specifications, lux levels, SDoCs, ies files and installation instructions.



Warranty
5 Years

L70 (36,000 h)

