

## Installation Instructions – PM279

## DALI-2 Driver LIM-12D 150-700mA

The LIM-12D DALI-2 driver may be used to add DALI control to most of the Switch Lighting range.

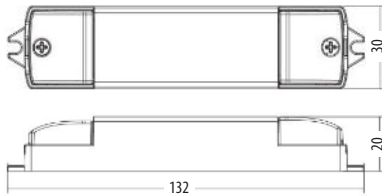

### Driver specifications:

**Rated AC supply:** 220-240V  
**AC frequency:** 50/60 Hz  
**Max input power:** 12W  
**Max output voltage (U-out):** ≤54V (open circuit)  
**Output ripple (<100 Hz):** <20%  
**Dimensions (LxWxH):** 132x30x20mm  
**DALI interface:** DALI-2  
**Min hole size to install:** 55mm

### Compatibility with Switch Lighting luminaires:

**Output current has been preset. Do not change!**

Refer to table below to determine how many series connected lights may be used.

Make all connections before applying power.

Switch Lighting	Driver Current		Lights	
	min	max	min	max
D-LIGHTZ	150	300	1	1
E-LIGHTZ	150	300	1	1
E-LIGHTZ-Mini	150	200	1	1
ZELA Fixed	150	200	1	1
ZELA (all other models)	150	250	1	1
SL900	150	350	2	3
SL900	500	500	2	2
SL201/211/SLDL614T	150	350	5	11
SLDL614T	500	500	5	7

Switch Lighting Order Code	
Suffix	Driver Current
D02	150mA
D03	200mA
D04	250mA

Switch Lighting Order Code	
Suffix	Driver Current
D05	300mA
D06	500mA
D07	350mA

### Insulation rating:

Check the insulation rating sticker on the luminaire:

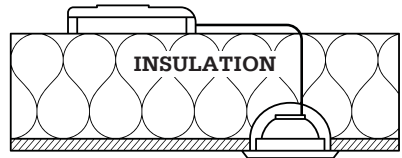

### Required clearance:

Required clearance from structural members and building elements:

**SCB** = 0mm      **HCB** = 0mm

### Insulation rating:

Check the insulation rating sticker on the luminaire:

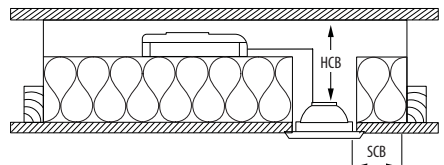

### Required clearance:

Required clearance from structural members and building elements:

**SCB** = 25mm      **HCB** = 25mm

### Unsuitable use:

The following lights are not suitable for use with this DALI driver:

**SL41, SL910, SL231/241, SL224/234**